

NOTES:

1. SUBSTRATE MATERIAL:  
FUSED SILICA
2. SURFACE S1 TO BE PARALLEL TO SURFACE S2 TO WITHIN <3 ARCMIN
3. COATING (APPLY ACROSS COATING APERTURE)  
S1: Square Aluminum (AlMgF2) Apertures  
R: 70±5% @ 250 - 2000nm @ 45° AOI  
T: 30±5% @ 250 - 2000nm @ 45° AOI
- S2: NONE
4. POLKA DOT CENTER TO CENTER SPACING : 0.15mm  
POLKA DOT MINIMUM APERTURE: 2mm
5. ROHS : COMPLIANT

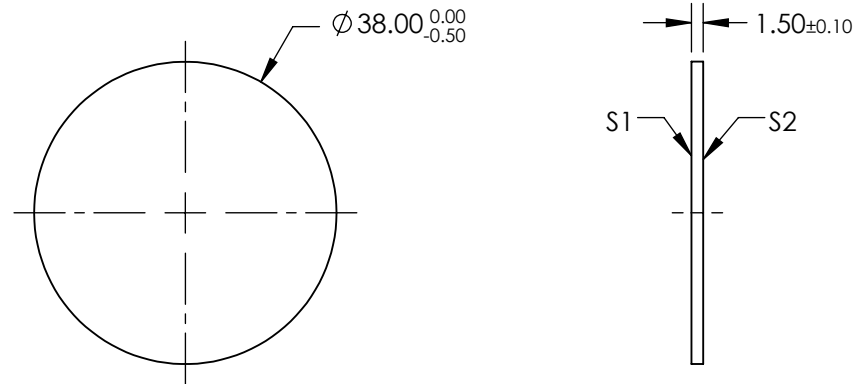
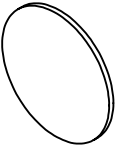

**FOR INFORMATION ONLY:  
DO NOT MANUFACTURE  
PARTS TO THIS DRAWING**

SPECIFICATIONS SUBJECT TO CHANGE WITHOUT NOTICE  
DIMENSIONS ARE FOR REFERENCE ONLY

	S1	S2	<b>Edmund Optics®</b>				
SHAPE	PLANO	PLANO					THIRD ANGLE PROJECTION
SURFACE QUALITY	80-50	80-50	ALL DIMS IN	mm	DWG NO	48504	SHEET 1 OF 1
CLEAR APERTURE	90%	90%					
BEVEL	PROTECTIVE AS NEEDED	PROTECTIVE AS NEEDED					