

NOTES:

1. SUBSTRATE MATERIAL:
Fused Silica
2. SURFACE S1 TO BE PARALLEL TO SURFACE S2 TO WITHIN <3 ARCMIN
3. COATING (APPLY ACROSS COATING APERTURE)
S1: Square Aluminum (AlMgF2) Apertures
R: 20±5% @ 250 - 2000 nm @ 45° AOI
T: 80±5% @ 250 - 2000 nm @ 45° AOI
S2: NONE
4. POLKA DOT CENTER TO CENTER SPACING : 0.15 mm
POLKA DOT MINIMUM APERTURE: 2mm
5. ROHS : COMPLIANT

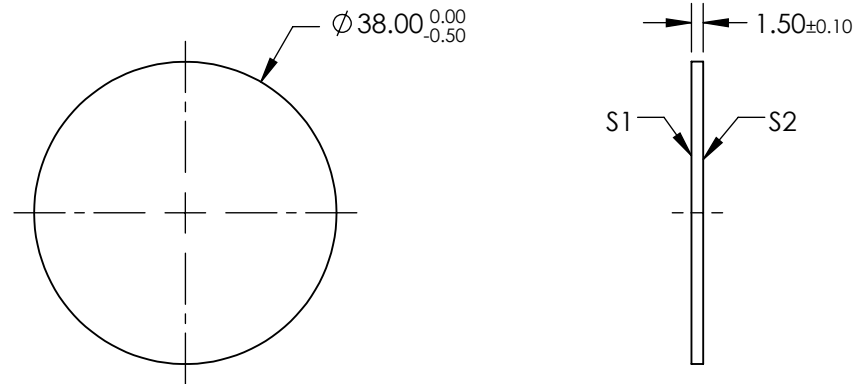
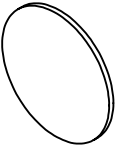

**FOR INFORMATION ONLY:
DO NOT MANUFACTURE
PARTS TO THIS DRAWING**

SPECIFICATIONS SUBJECT TO CHANGE WITHOUT NOTICE
DIMENSIONS ARE FOR REFERENCE ONLY

	S1	S2				
SHAPE	PLANO	PLANO				
SURFACE QUALITY	80-50	80-50		TITLE	38.0mm Dia 20R/80T, UV-NIR Polka-Dot Beamsplitter	
CLEAR APERTURE	∅ 34.2	∅ 34.2		ALL DIMS IN	DWG NO	18712
BEVEL	PROTECTIVE AS NEEDED	PROTECTIVE AS NEEDED	mm			