

8-32 UNC AND M4 TAP
FOR POST AND RACK MOUNTING
▽ 8.0mm [0.31in]

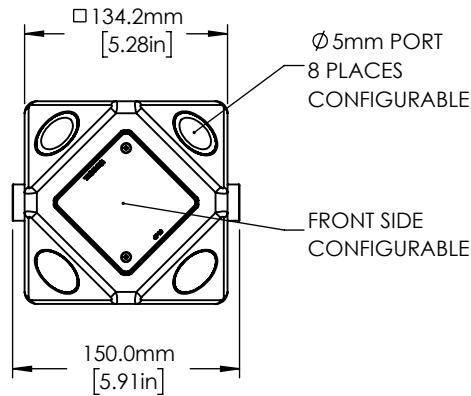

Ø 5mm PORT
8 PLACES
CONFIGURABLE

FRONT SIDE
CONFIGURABLE

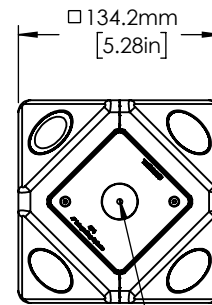

REAR SIDE
CONFIGURABLE

8-32 UNC AND M4 TAP
FOR POST AND RACK MOUNTING
▽ 8.0mm [0.31in]

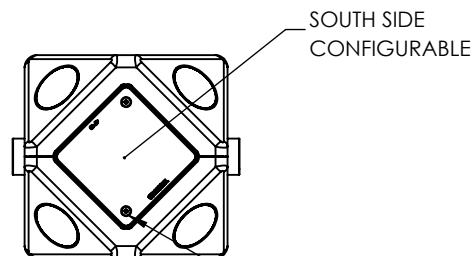

SOUTH SIDE
CONFIGURABLE

M3 x 8 COUNTERSUNK SCREW
2mm [5/64in] HEX
2 PLACES ON EACH SIDE

CONFIGURATIONS SELECTED BY CUSTOMER
IN WEB CONFIGURATION TOOL

FOR INFORMATION ONLY
NOT FOR MANUFACTURING PURPOSES

DRAWING PROJECTION			THORLABS www.thorlabs.com	
NAME	DATE	100 mm Integrating Sphere with 4 Modular Faces		
DRAWN	MG	04/NOV/19	REV A	
APPROVAL	GO	04/NOV/19	MATERIAL	N/A
COPYRIGHT ©2019 BY THORLABS			ITEM #	APPROX WEIGHT
VALUES IN PARENTHESIS ARE CALCULATED AND MAY CONTAIN ROUND OFF ERRORS			4P4-CUSTOM	2.5 kg