

	PART DESCRIPTION	MATERIAL
①	SM2RR	ANODIZED ALUMINUM
②	LA4745	UV FUSED SILICA
③	ENGRAVED HOUSING	ANODIZED ALUMINUM

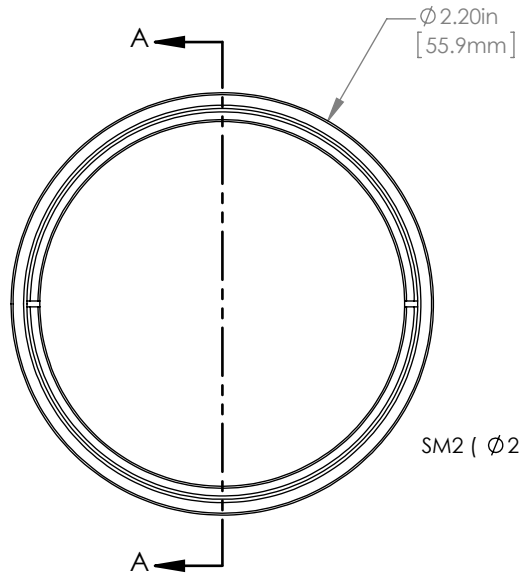

SM2 ( Ø 2.035-40) SERIES INTERNAL THREAD

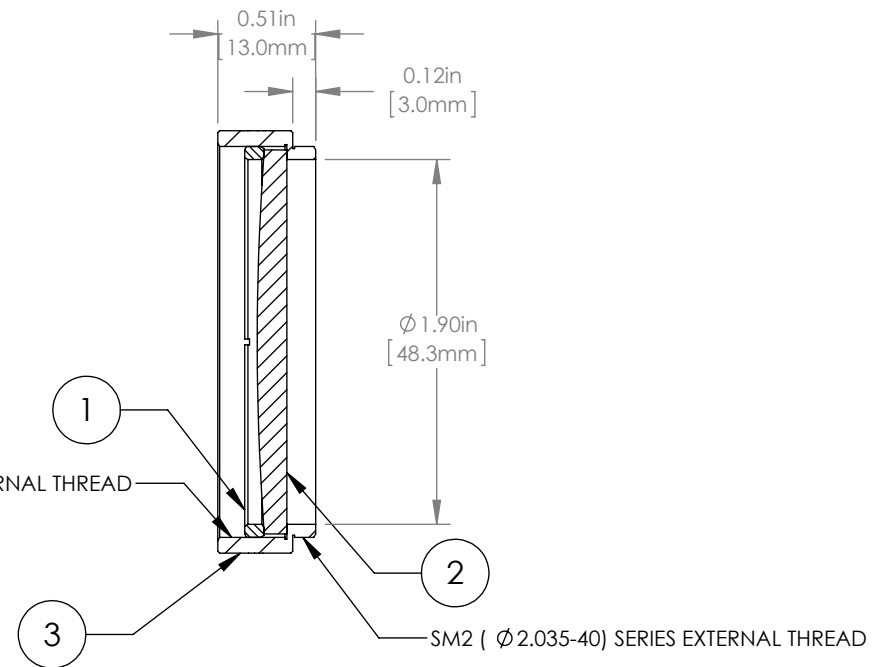

NOTES/SPECIFICATIONS:

1. DESIGN WAVELENGTH: 546nm
2. FOCAL LENGTH:  $f=750.0\text{mm} \pm 1\%$
3. WORKING DISTANCE (REF): 743.5mm
4. CLEAR APERTURE:  $> \text{Ø } 45.72\text{mm}$
5. SURFACE QUALITY: 40-20 SCRATCH-DIG

FOR INFORMATION ONLY  
NOT FOR MANUFACTURING PURPOSES

DRAWING PROJECTION			<b>THORLABS</b> www.thorlabs.com Ø 2" MOUNTED PLANO-CONVEX LENS, $f=750\text{mm}$	
NAME	DATE			
DRAWN	GG	13/OCT/15	MATERIAL SEE TABLE	
APPROVAL	DD	13/OCT/15		
COPYRIGHT © 2015 BY THORLABS			ITEM #	APPROX WEIGHT
VALUES IN PARENTHESIS ARE CALCULATED AND MAY CONTAIN ROUND OFF ERRORS			LA4745-ML	29 g