

ISOMETRIC VIEW
SCALE 1:1

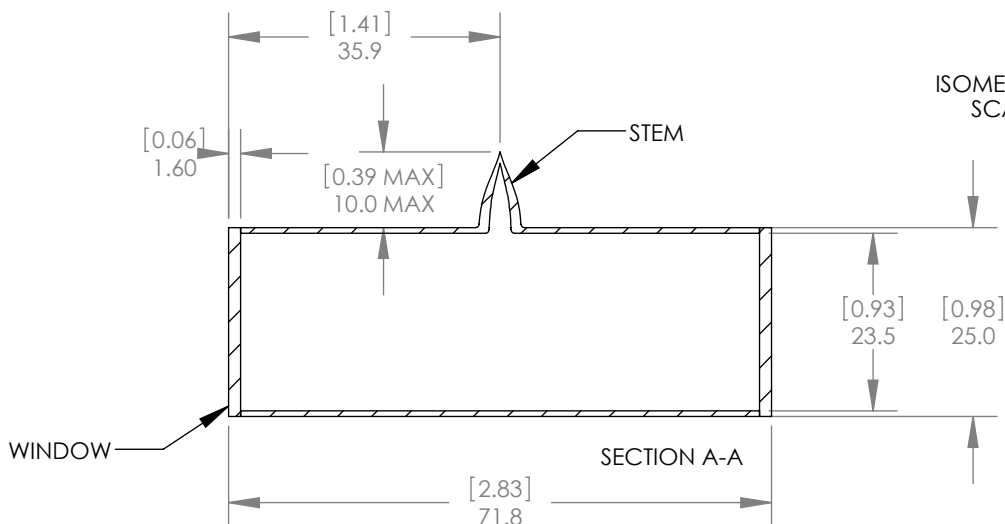
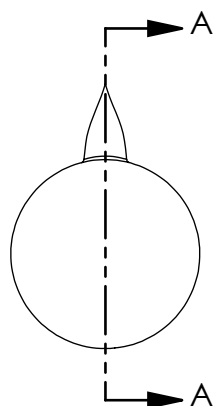

NOTES/SPECIFICATIONS:

1. BODY THICKNESS: 1.5mm
2. DIAMETER TOLERANCE: ± 1.6 mm
3. DIMENSIONAL TOLERANCE: ± 0.8 mm
4. PRESSURE @ 25°C: $>10^{-7}$ TORR
5. STEM HEIGHT: <10 mm
6. WINDOW ANGLE: 0°
7. WINDOW TYPE: FLAT
8. WINDOW THICKNESS: 1.6mm
9. WINDOW SURFACE QUALITY: 60-40 SCRATCH-DIG
10. MINIMUM TRANSMISSION: $>84\%$
11. GAS: CESIUM Cs
12. WAVELENGTH: 852nm
- 13.
14. ALL DIMENSIONS ARE IN $\frac{[in]}{mm}$

FOR INFORMATION ONLY
NOT FOR MANUFACTURING PURPOSES

DRAWING PROJECTION			THORLABS www.thorlabs.com	
NAME	DATE	PYREX REF. CELL		
DRAWN	MG	22/MAR/11	Ø25 mm x 71.8 mm, Cesium [Cs]	
APPROVAL	WD	22/MAR/11	MATERIAL	REV
COPYRIGHT © 2010 BY THORLABS			PYREX/SCHOTT BOROFLOAT	C
VALUES IN PARENTHESIS ARE CALCULATED AND MAY CONTAIN ROUND OFF ERRORS		ITEM #	APPROX WEIGHT	
		CP25075-CS	0.06 kg	