

	PART DESCRIPTION	MATERIAL
①	ENGRAVED SM1L05	ANODIZED ALUMINUM
②	SM1RR	ANODIZED ALUMINUM
③	LA1951-C	N-BK7

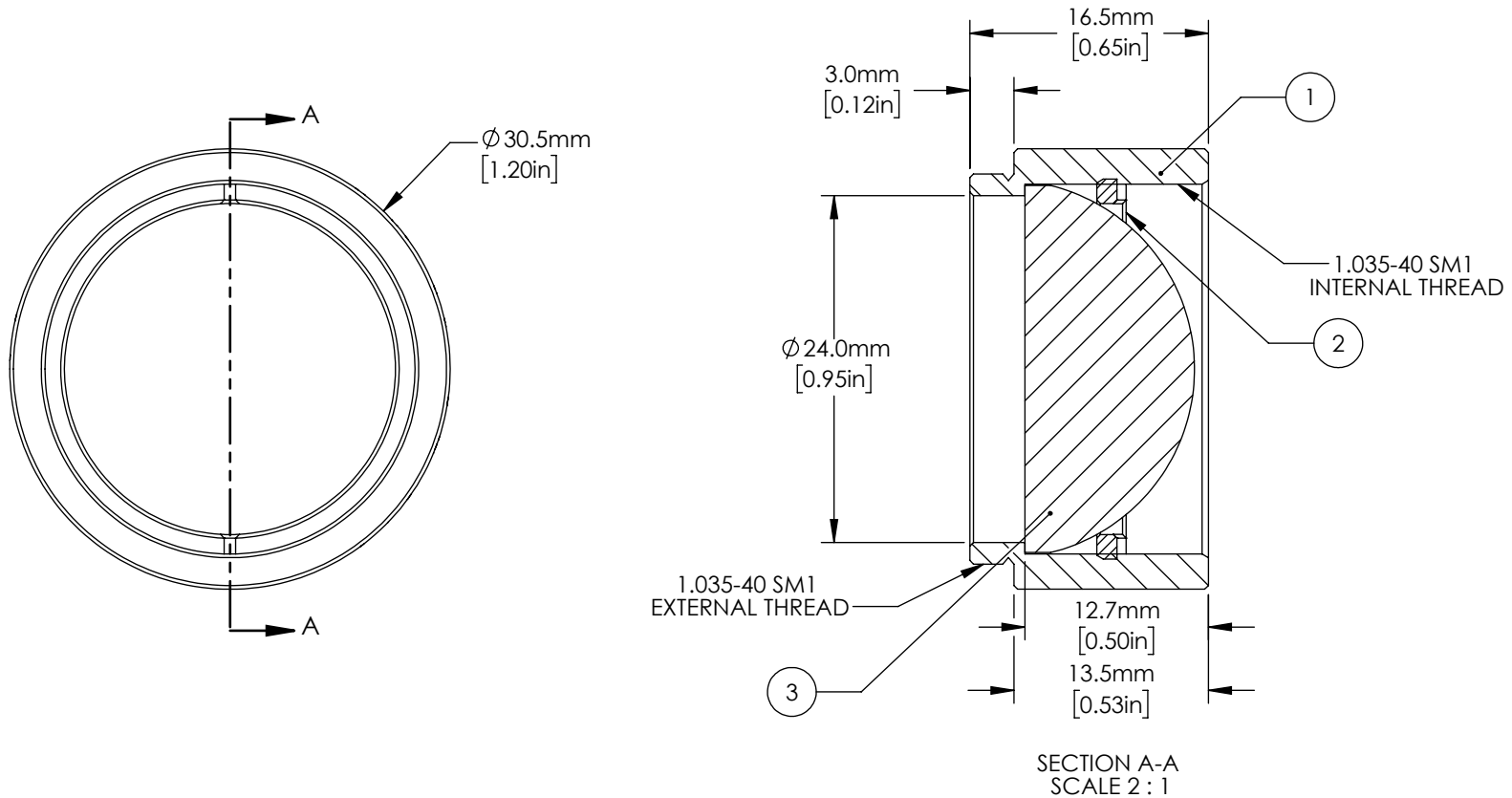

NOTES/SPECIFICATIONS:

1. DESIGN WAVELENGTH: 633 nm
2. FOCAL LENGTH: $f=25.4 \text{ mm} \pm 1\%$
3. WORKING DISTANCE: 13.8 mm
4. CLEAR APERTURE: $> \text{Ø} 22.86 \text{ mm}$
5. SURFACE QUALITY: 40-20 SCRATCH-DIG
6. COATING: BBAR $R_{\text{avg}} < 0.5\%$ FROM 1050 nm-1700 nm, 0 AOI, ON OUTER OPTICAL SURFACES

FOR INFORMATION ONLY
NOT FOR MANUFACTURING PURPOSES

DRAWING PROJECTION			 www.thorlabs.com	
NAME	DATE			
DRAWN	CR	27/JUN/12	PLANO-CONVEX LENS, Ø1" , SM1-THREADED MOUNT, $f = 25.4 \text{ mm}$, C-COAT	
APPROVAL	BAG	24/NOV/21	MATERIAL	REV B
COPYRIGHT © 2021 BY THORLABS			SEE TABLE	
VALUES IN PARENTHESIS ARE CALCULATED AND MAY CONTAIN ROUND OFF ERRORS			ITEM #	APPROX WEIGHT
			LA1951-C-ML	0.041 kg