

	PART DESCRIPTION	MATERIAL
①	SM1RR	ANODIZED ALUMINUM
②	LA1464	N-BK7
③	ENGRAVED HOUSING	ANODIZED ALUMINUM

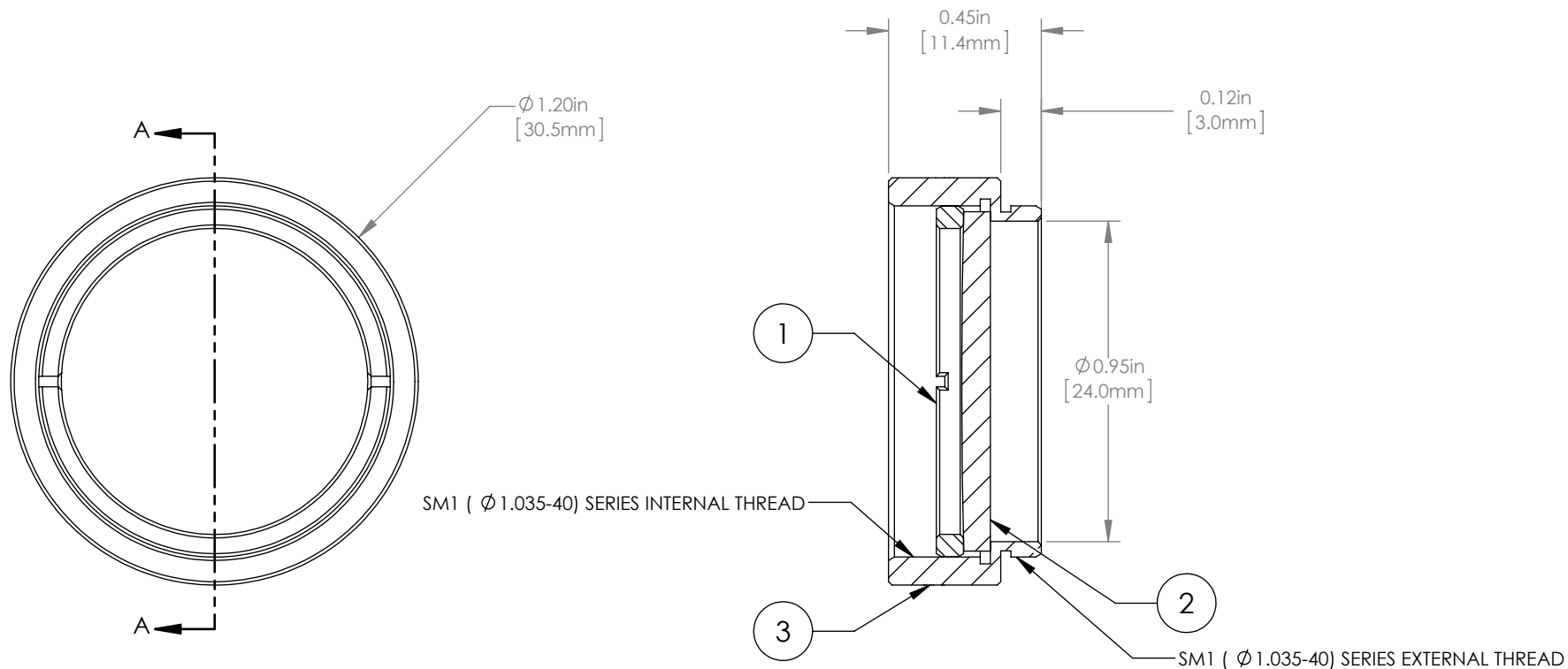

NOTES/SPECIFICATIONS:

1. DESIGN WAVELENGTH: 587.6nm
2. FOCAL LENGTH:  $f=996.7\text{mm} \pm 1\%$
3. WORKING DISTANCE (REF): 991.5mm
4. CLEAR APERTURE:  $> \varnothing 22.86\text{mm}$
5. SURFACE QUALITY: 40-20 SCRATCH-DIG
6. CENTRATION:  $< 3\text{arcmin}$

FOR INFORMATION ONLY  
NOT FOR MANUFACTURING PURPOSES

DRAWING PROJECTION						<b>THORLABS</b> www.thorlabs.com	
NAME	DATE	$\varnothing 1"$ MOUNTED PLANO CONVEX LENS, $f=1000\text{mm}$				REV	A
DRAWN	GG	30/JUN/15	MATERIAL				SEE TABLE
APPROVAL	DD	30/JUN/15	ITEM #				APPROX WEIGHT
COPYRIGHT © 2015 BY THORLABS				LA1464-ML		8 g	
<small>VALUES IN PARENTHESIS ARE CALCULATED AND MAY CONTAIN ROUND OFF ERRORS</small>							