

	PART DESCRIPTION	MATERIAL
①	SM2RR	ANODIZED ALUMINUM
②	LA4904	UV FUSED SILICA
③	ENGRAVED HOUSING	ANODIZED ALUMINUM

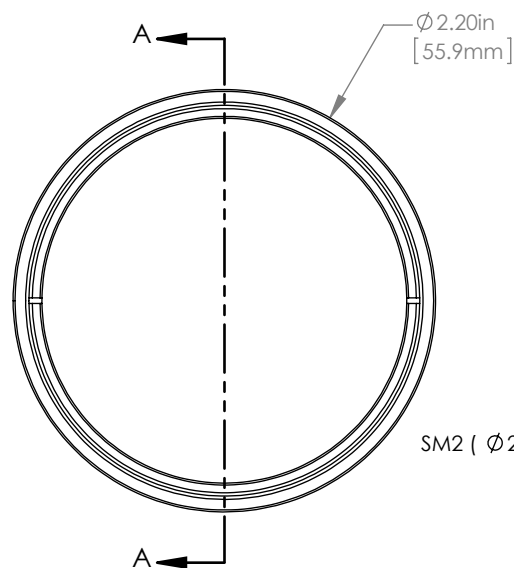

SM2 ($\phi 2.035\text{-}40$) SERIES INTERNAL THREAD

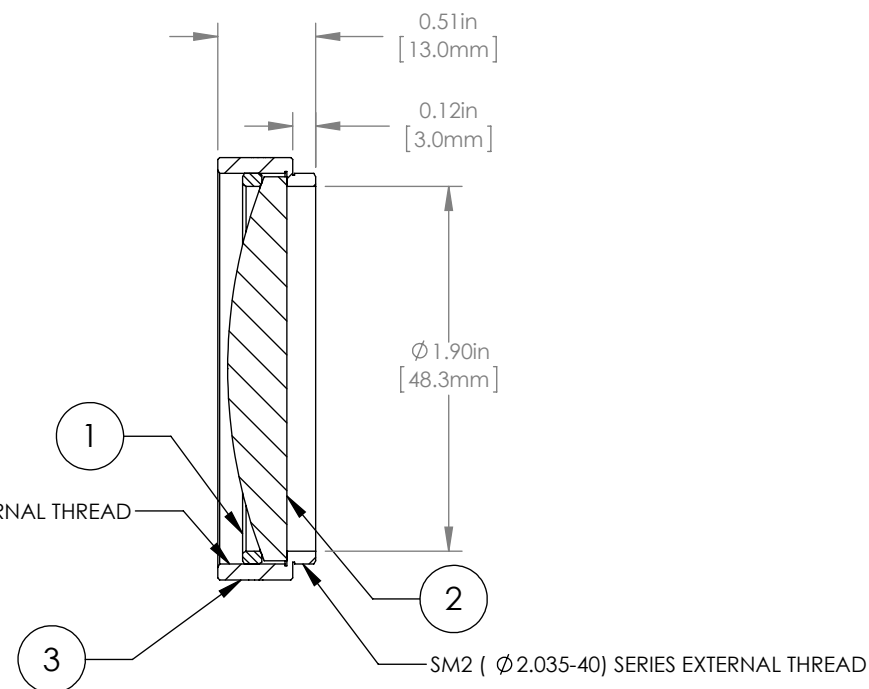

NOTES/SPECIFICATIONS:

- DESIGN WAVELENGTH: 546nm
- FOCAL LENGTH: $f=150.0\text{mm} \pm 1\%$
- WORKING DISTANCE (REF): 140.8mm
- CLEAR APERTURE: $> \phi 45.72\text{mm}$
- SURFACE QUALITY: 40-20 SCRATCH-DIG

FOR INFORMATION ONLY
NOT FOR MANUFACTURING PURPOSES

DRAWING PROJECTION			THORLABS www.thorlabs.com $\phi 2"$ MOUNTED PLANO-CONVEX LENS, $f=150\text{mm}$	
NAME	DATE			
DRAWN	GG	08/FEB/16	MATERIAL SEE TABLE	
APPROVAL	DD	08/FEB/16		
COPYRIGHT © 2016 BY THORLABS			ITEM #	APPROX WEIGHT
VALUES IN PARENTHESIS ARE CALCULATED AND MAY CONTAIN ROUND OFF ERRORS			LA4904-ML	38 g