

	PART DESCRIPTION	MATERIAL
①	SM1RR	ANODIZED ALUMINUM
②	LA1464-B	N-BK7
③	ENGRAVED HOUSING	ANODIZED ALUMINUM

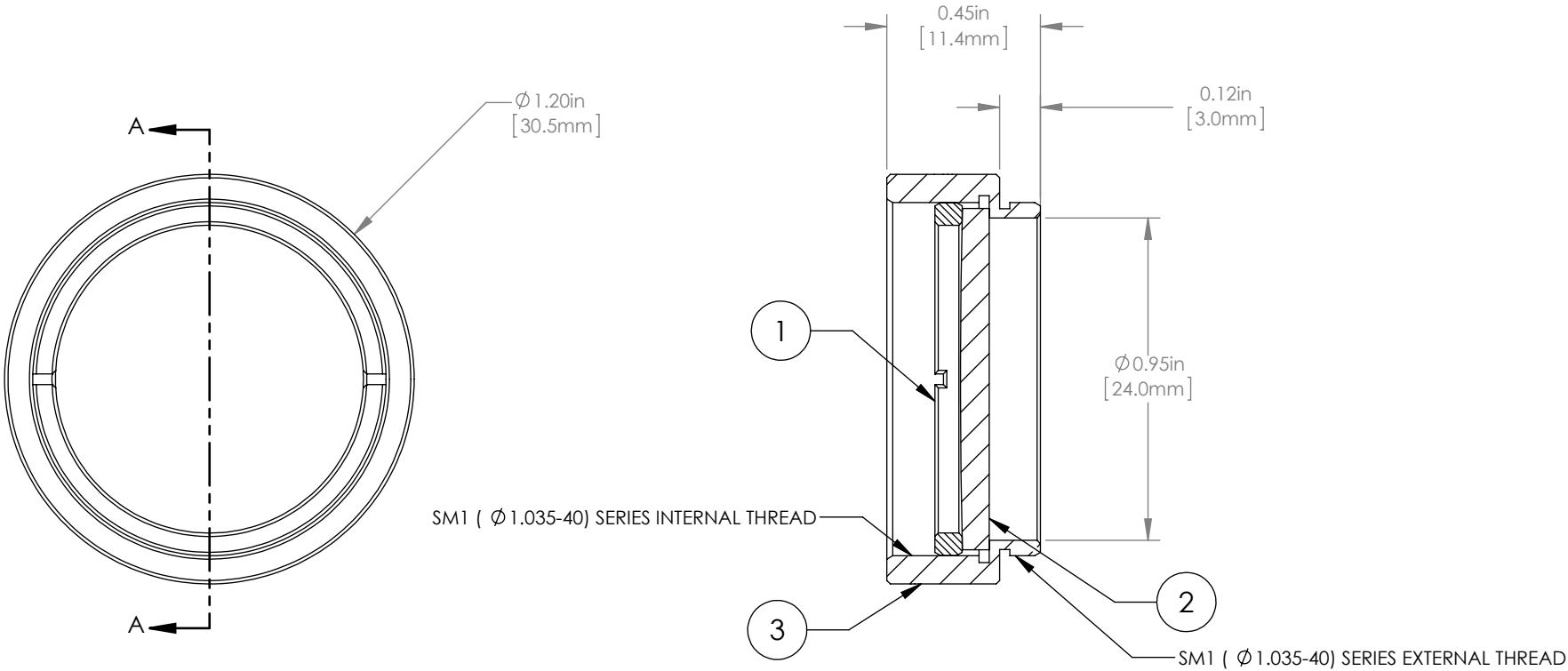

NOTES/SPECIFICATIONS:

- DESIGN WAVELENGTH: 587.6nm
- FOCAL LENGTH: f=996.7mm±1%
- WORKING DISTANCE (REF): 991.5mm
- CLEAR APERTURE: > $\varnothing 22.86\text{mm}$
- SURFACE QUALITY: 40-20 SCRATCH-DIG
- CENTRATION: <3arcmin
- COATING: BBAR Ravg<0.5% FROM 650-1050nm, AOI: 0°, ON OUTER OPTICAL SURFACES

FOR INFORMATION ONLY
NOT FOR MANUFACTURING PURPOSES

DRAWING PROJECTION			<div>THORLABS</div> <div>www.thorlabs.com</div> <div>Ø 1" MOUNTED PLANO CONVEX LENS, f=1000mm, -B COAT</div>	
	NAME	DATE		
DRAWN	GG	30/JUN/15	MATERIAL	
APPROVAL	DD	30/JUN/15		
COPYRIGHT © 2015 BY THORLABS			SEE TABLE	
VALUES IN PARENTHESIS ARE CALCULATED AND MAY CONTAIN ROUND OFF ERRORS			ITEM #	APPROX WEIGHT
			LA1464-B-ML	8 g