

INCLUDED BUT NOT SHOWN: EIGHT 4-40 COUNTERSUNK SCREWS AND 1/16in HEX KEY FOR COUNTERSUNK SCREW

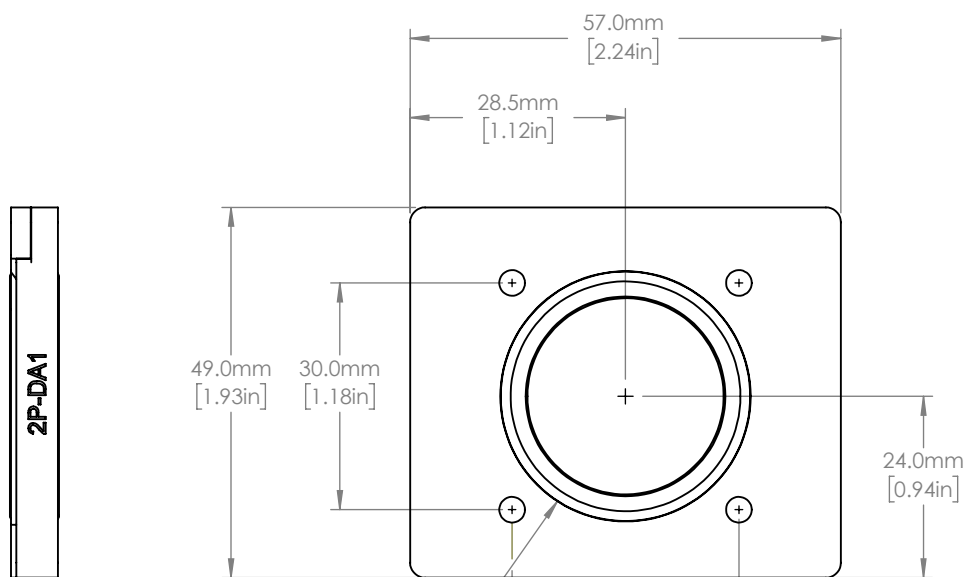

Ø3.4mm [0.13in] MOUNTING HOLES 8 PLACES FOR MOUNTING OF 2P-DA1 TO THE INTEGRATING SPHERE USING COUNTERSUNK SCREWS (INCLUDED)

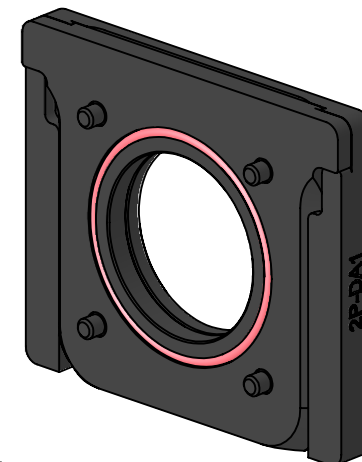
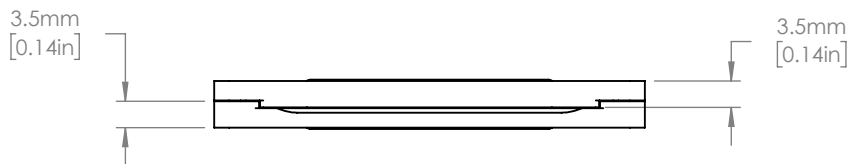
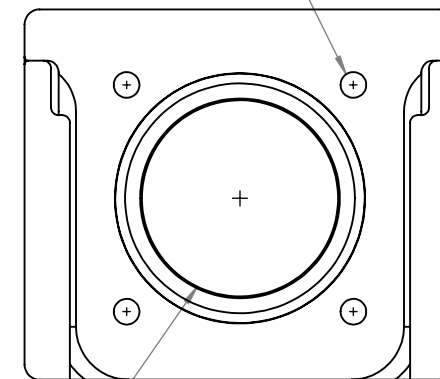
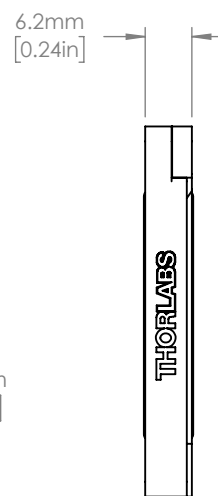

SILICONE RING ENSURES LIGHT-TIGHT CONNECTION AT ALL INTERFACES.

SM1 [1.035-40] SERIES INTERNAL CONTINUOUS THREAD BOTH PARTS

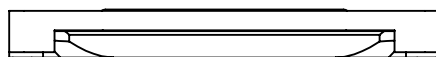

FOR INFORMATION ONLY  
NOT FOR MANUFACTURING PURPOSES

DRAWING PROJECTION			<b>THORLABS</b> www.thorlabs.com	
NAME	DATE	Slim Adapter for Ø50 mm Integrating Sphere		
DRAWN	03/Feb/22	MATERIAL		REV
APPROVAL	05/Feb/22	N/A		A
COPYRIGHT ©2022 BY THORLABS		ITEM #	APPROX WEIGHT	
VALUES IN PARENTHESIS ARE CALCULATED AND MAY CONTAIN ROUND OFF ERRORS		2P-DA1	37.8 g	