

4 Metal Foil Strain Gauges (2 this Side, 2 Opposite)
 Connected in Wheatstone Bridge Configuration

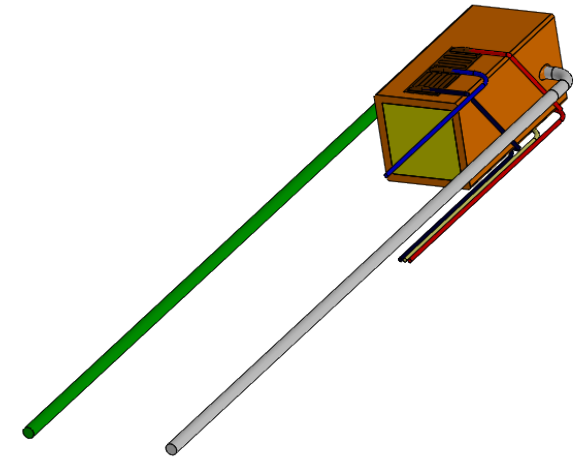

+V_{output} Strain Gauge Wire, Blue*

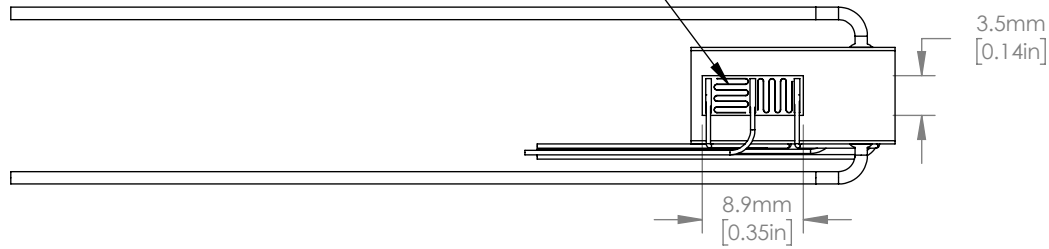
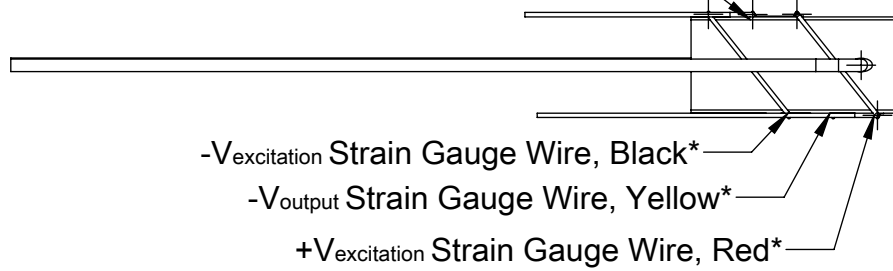

-V_{excitation} Strain Gauge Wire, Black*

-V_{output} Strain Gauge Wire, Yellow*

+V_{excitation} Strain Gauge Wire, Red*

* All Strain Gauge Wires are 260mm(10.2in)
 Long with 0.5mm(0.02in) Outer Diameter

Negative Actuator Wire, White, ~75mm(2.95in)
 Long with 0.7mm(0.03in) Outer Diameter

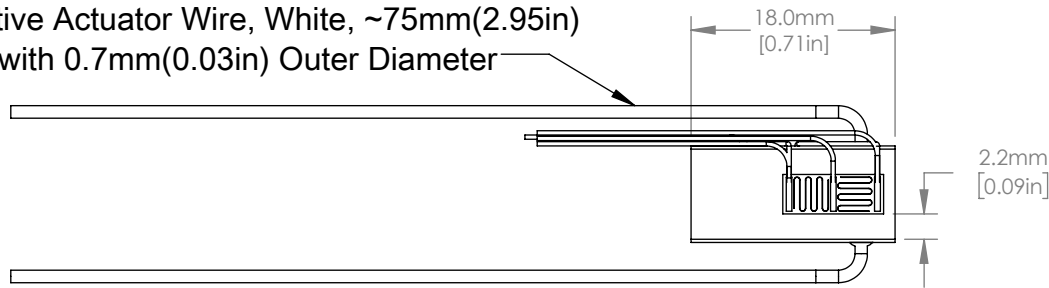

Positive Actuator Wire, Green, ~75mm(2.95in)
 Long with 0.7mm(0.03in) Outer Diameter

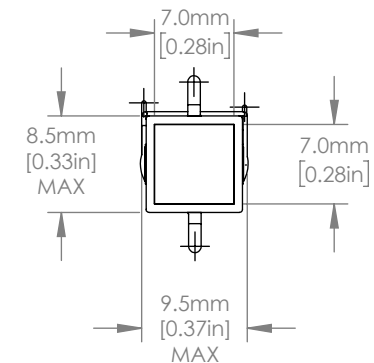

FOR INFORMATION ONLY
 NOT FOR MANUFACTURING PURPOSES

DRAWING PROJECTION			THORLABS www.thorlabs.com	
NAME	DATE	PIEZO ACTUATOR		
DRAWN	Y N	15/MAR/21	REV A	
APPROVAL	RG	15/MAR/21	MATERIAL	N/A
COPYRIGHT © 2021 BY THORLABS			ITEM #	APPROX WEIGHT
VALUES IN PARENTHESIS ARE CALCULATED AND MAY CONTAIN ROUND OFF ERRORS			PC4GQC2	8.42g