

PIN IDENTIFICATION	
1. TEC +	14. TEC -
2. Thermistor	13. Case
3. NC	12. NC
4. NC	11. Dev Cathode
5. Thermistor	10. Dev Anode
6. NC	9. NC
7. NC	8. NC

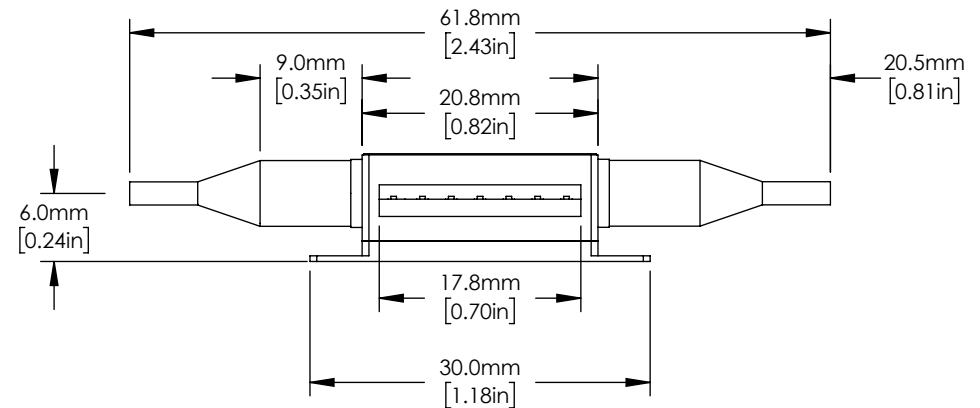
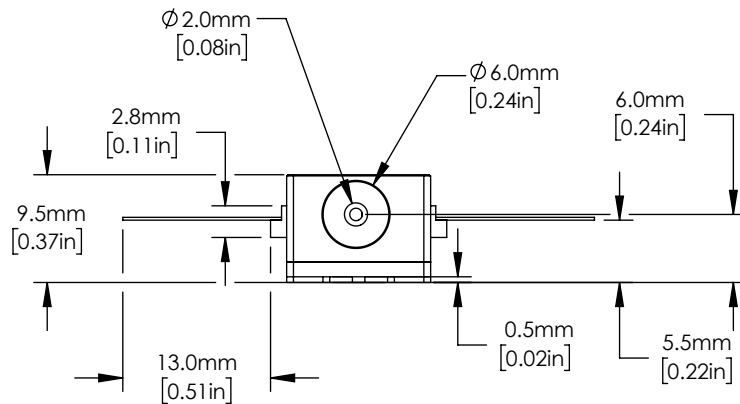
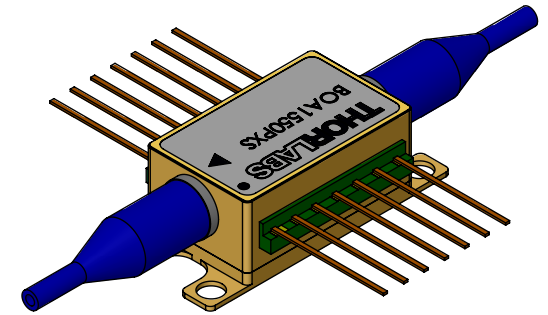

NOTES:

- THE DEVICE IS SUPPLIED WITH 2 ATTACHED FIBER TAILS.
- FIBER TAIL DETAILS:
 - LENGTH: 1.5m \pm 0.1m [4.9ft \pm 0.3ft]
 - TERMINATION: FC/APC CONNECTORS
 - FIBER TYPE: PM1550
- RECOMMENDED MOUNTING TORQUE: 10 - 20 oz-in (0.07 - 0.14 N·m)

FOR INFORMATION ONLY
NOT FOR MANUFACTURING PURPOSES

DRAWING PROJECTION			THORLABS www.thorlabs.com 1550 nm Polarization-Dependent Optical Shutter/Switch	
NAME	DATE			
DRAWN PS	20/JUL/22		MATERIAL	
APPROVAL WQ	20/JUL/22		N/A	
COPYRIGHT © 2022 BY THORLABS			REV A	
VALUES IN PARENTHESIS ARE CALCULATED AND MAY CONTAIN ROUND OFF ERRORS			ITEM #	APPROX WEIGHT
			BOA1550PXS	0.025 kg