

NOTES:

1. SUBSTRATE:
N-BK7

2. BEAM DEVIATION: ≤ 2 ARCMIN

3. COATING (APPLY ACROSS CLEAR APERTURE):
VIS (430-670nm)
S2, S3, S4: $R_{avg} < 0.5\%$ @ 430 - 670nm
S5: MULTILAYER DIELECTRIC TO ACHIEVE:
TRANSMISSION $> 45\% \pm 10\%$
POLARIZATION $< 6\%$

4. ELEMENTS CEMENTED WITH NORLAND OPTICAL
ADHESIVE NOA 61

5. ABSORPTIVE SURFACE TREATMENT, INCLUDING BEVEL

6. DIMENSIONS APPLY AFTER SURFACE TREATMENT

7. MARK IDENTIFIES BEAMSPLITTER COATED RIGHT ANGLE
PRISM

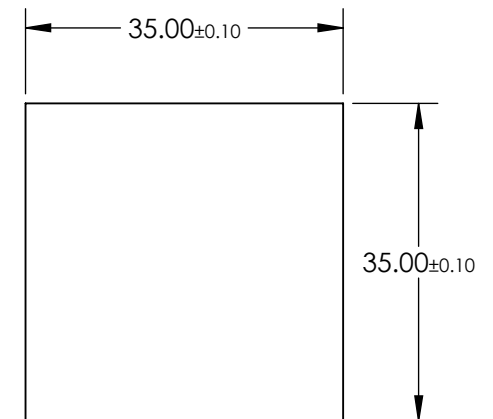
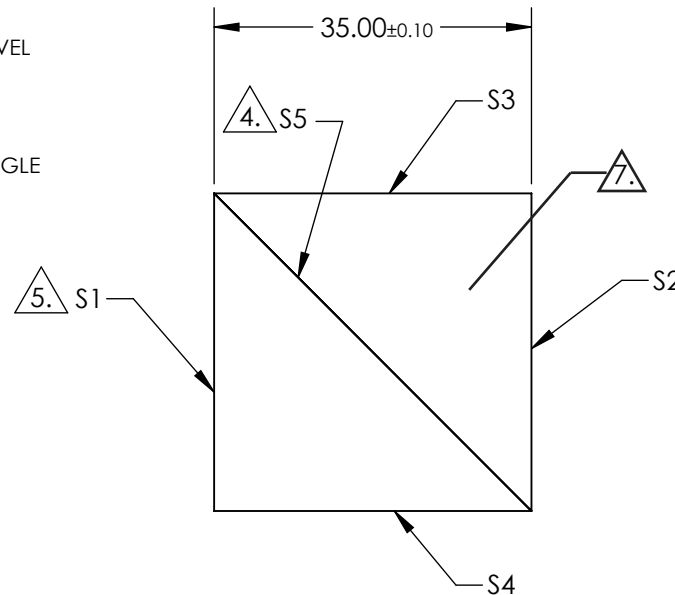
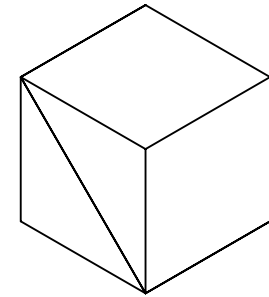

**FOR INFORMATION ONLY:
DO NOT MANUFACTURE
PARTS TO THIS DRAWING**

SPECIFICATIONS SUBJECT TO CHANGE WITHOUT NOTICE
DIMENSIONS ARE FOR REFERENCE ONLY

| | |
|------------------|---------------------|
| | S2, S3, S4 |
| SHAPE | PLANO |
| SURFACE FLATNESS | $\lambda/8$ |
| SURFACE QUALITY | 40 - 20 |
| CLEAR APERTURE | $> 90\%$ |
| BEVEL | PROTECTED AS NEEDED |

| | | | |
|-------------|----|----------------------|--|
| | | Edmund Optics | |
| | | TITLE | 35mm VIS, 50R/50T, Non-Polarizing In-Line Cube Beamsplitter |
| ALL DIMS IN | mm | DWG NO | 20097 |
| | | | SHEET 4 OF 5 |