

AE0203D04F

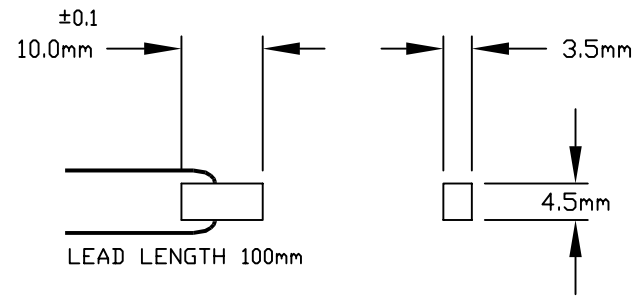

AE0203D08F

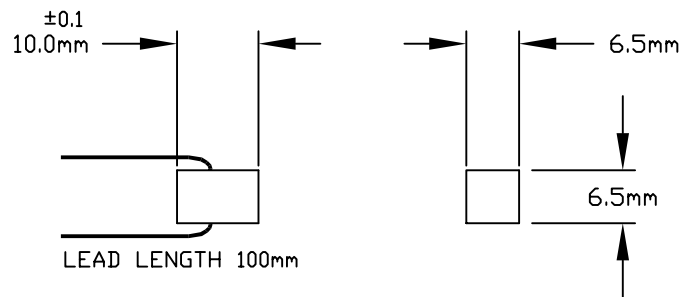

AE0505D08F

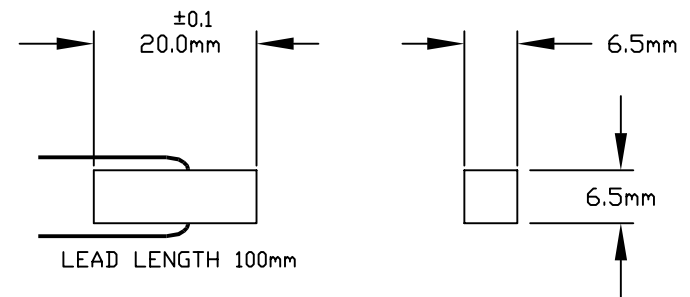

AE0505D16F

NOTES;
RESIN COATED PIEZOELECTRIC CERAMIC

THORLABS PO BOX 366 NEWTON NJ			
TITLE PIEZOELECTRIC ACTUATORS			
TOL: X.XXX=+/-0.005 X.XX=+/-0.010 ANGULAR +/--30'			
MATERIAL SEE NOTES			WHERE USED
DRAWN AC	ENGR. AC	APPROVED AC	ENGINEERING SUPPORT DRAWING
DATE 07/27/06	REV A	SIZE A	
DWG NO. 15639-E01	PART NO.	SHEET 1 OF 1	