

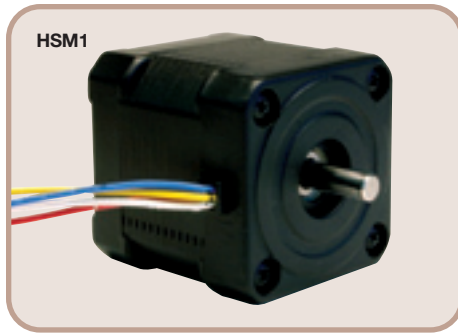

The Power Behind the DRV Actuators



Specifications

- **Step Angle:** 1.8°
- **Step Angle Accuracy:** 5%
- **Rated Phase Current:** 1A
- **Phase Resistance:** 4.6Ω
- **Phase Inductance:** 0.6mH
- **Holding Torque Unipolar:** N/A
- **Holding Torque Bipolar:** 23.1N-cm
- **Detent Torque:** 1.7N-cm
- **Rotor Inertia:** 32g-cm²
- **Insulation Class:** B

For customers wanting to build their own actuators, Thorlabs offers this bare stepper motor, ideal for use in a wide range of custom applications.

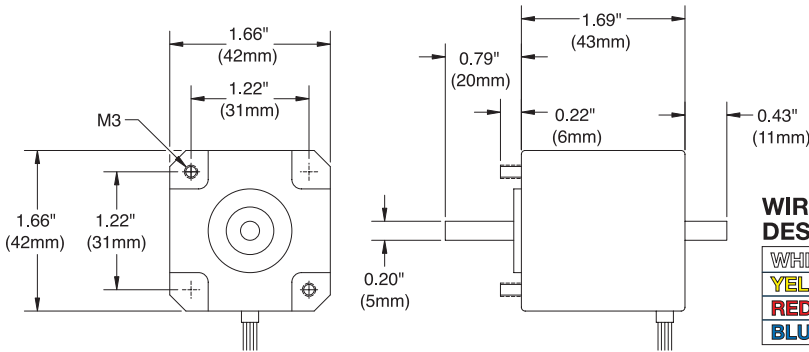

WIRE DESCRIPTION

WHITE:	PHB+
YELLOW:	PHB-
RED:	PHA+
BLUE:	PHA-

See our Full Line of Motor Controllers on Pages 331-338



ITEM#	\$	£	€	¥	DESCRIPTION
HSM1	\$ 79.90	£ 47.00	€ 70,50	¥ 13,160	Hybrid Stepper Motor

Modular Stepper Motor Actuator – 8mm Travel

These Modular Stepper Motor Actuators are ideal for short travel stages equipped with the Modular Quick-Connect adapter. With 8mm of travel at a resolution of 25nm, this actuator is capable of speeds as high as 4mm/sec. The powerful stepper motor is capable of handling a load capacity of up to 48lbs. (22kg.) Bidirectional repeatability is less than 1.0µm RMS.

- Ideal for 4mm Travel Stages
- 8mm Total Travel
- 25nm Resolution
- Non-rotating Tip
- Manual Adjuster Knob Provided
- 4mm/Second Max Speed
- 48 lbs. (22kg) Load Capacity
- Compatible with Modular Quick-Connect Adapter

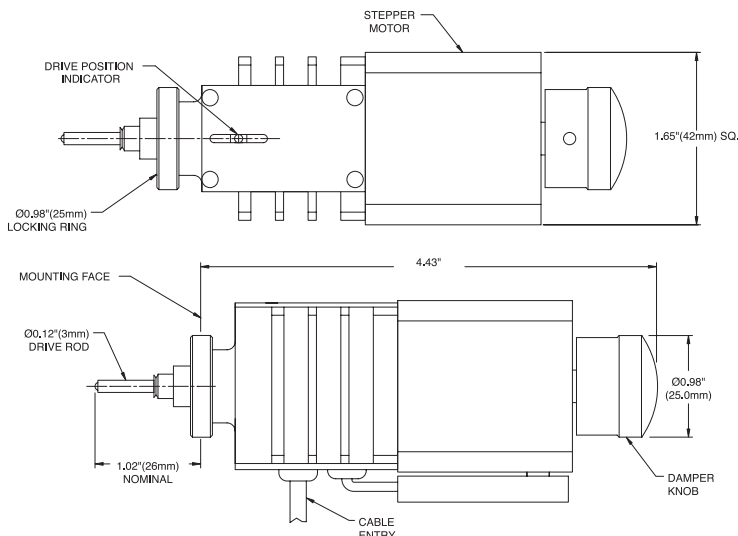

ITEM#	\$	£	€	¥	DESCRIPTION
DRV001	\$ 586.50	£ 345.00	€ 517,50	¥ 96,600	8mm Travel Stepper Motor Actuator