

NOTES:

1. SUBSTRATE: Germanium (Ge)
2. RoHS: COMPLIANT
3. SURFACE S2 TO BE PARALLEL TO SURFACE S1 TO WITHIN <1 ARCMIN
4. COATING (APPLY ACROSS CLEAR APERTURE)

S1 & S2: NONE

5. FINE GRIND SURFACE

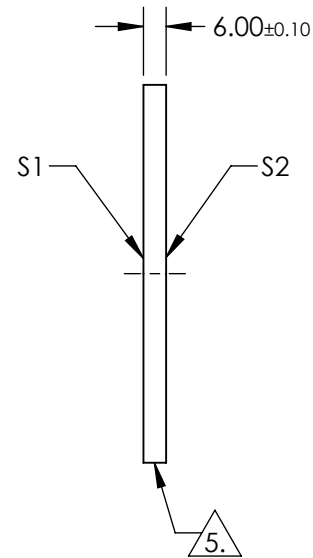
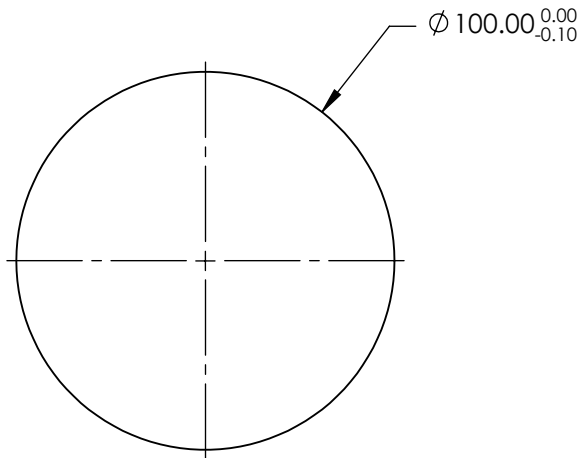
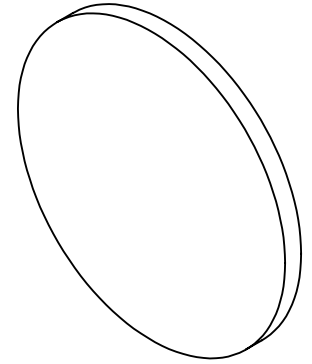

**FOR INFORMATION ONLY:  
DO NOT MANUFACTURE  
PARTS TO THIS DRAWING**

SPECIFICATIONS SUBJECT TO CHANGE WITHOUT NOTICE  
DIMENSIONS ARE FOR REFERENCE ONLY

	S1	S2
SHAPE	PLANO	PLANO
SURFACE QUALITY	60-40	60-40
CLEAR APERTURE	$\varnothing 90.00$	$\varnothing 90.00$
SURFACE FLATNESS	$\lambda/10$	$\lambda/10$
BEVEL	PROTECTED AS NEEDED	PROTECTED AS NEEDED



ALL DIMS IN

mm

**EO**® Edmund Optics®

TITLE

100mm Dia. x 6mm Thick, Uncoated, Ge Window

DWG NO

17669

SHEET  
1 OF 1