

ISOMETRIC VIEW
SCALE 1:1

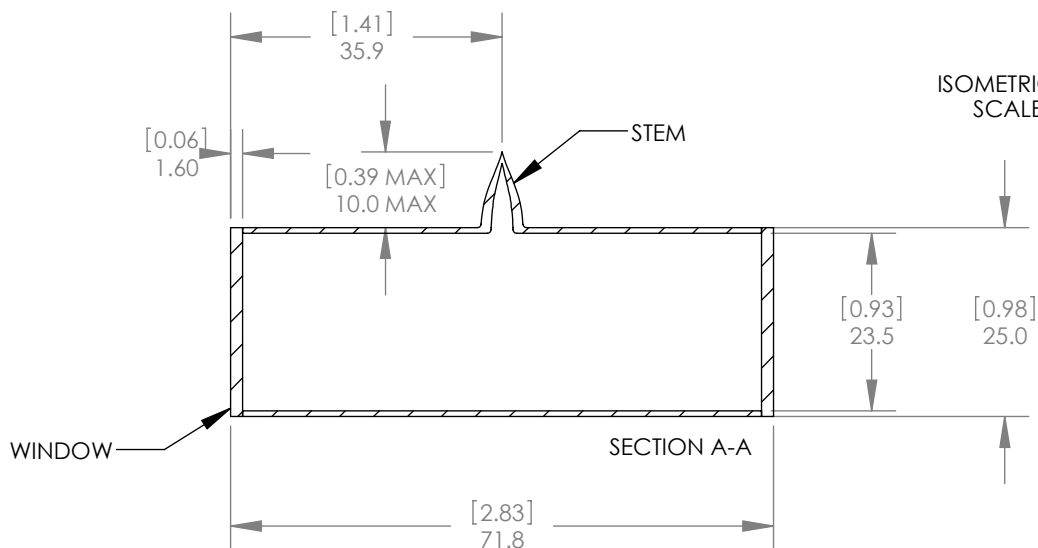
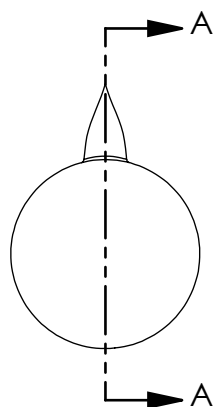

NOTES/SPECIFICATIONS:

1. BODY THICKNESS: 1.5mm
2. DIAMETER TOLERANCE: ±1.6mm
3. DIMENSIONAL TOLERANCE: ±0.8mm
4. PRESSURE @ 25°C: >10⁻⁷ TORR
5. STEM HEIGHT: <10mm
6. WINDOW ANGLE: 0°
7. WINDOW TYPE: FLAT
8. WINDOW THICKNESS: 1.6mm
9. WINDOW SURFACE QUALITY: 60-40 SCRATCH-DIG
10. MINIMUM TRANSMISSION: >84%
11. GAS: RUBIDIUM Rb
12. WAVELENGTH: 780nm
- 13.
14. ALL DIMENSIONS ARE IN $\begin{matrix} [in] \\ mm \end{matrix}$

FOR INFORMATION ONLY
NOT FOR MANUFACTURING PURPOSES

DRAWING PROJECTION			THORLABS www.thorlabs.com	
NAME	DATE	PYREX REF. CELL Ø25 mm x 71.8 mm, RUBIDIUM [Rb]		
DRAWN	MG	22/MAR/11	MATERIAL	
APPROVAL	WD	22/MAR/11	PYREX/SCHOTT BOROFLOAT	REV C
COPYRIGHT © 2010 BY THORLABS				
VALUES IN PARENTHESIS ARE CALCULATED AND MAY CONTAIN ROUND OFF ERRORS			ITEM #	APPROX WEIGHT
			CP25075-RB	0.06 kg