

OUTPUT (BNC): 0-10 V max. POWER CONNECTOR

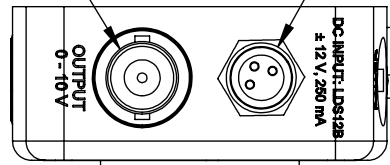

SM1 (1.035-40) SERIES EXTERNAL THREAD



0.13in ±0.01
[3.3mm ±0.3]
DETECTOR ACTIVE
AREA SURFACE OFFSET

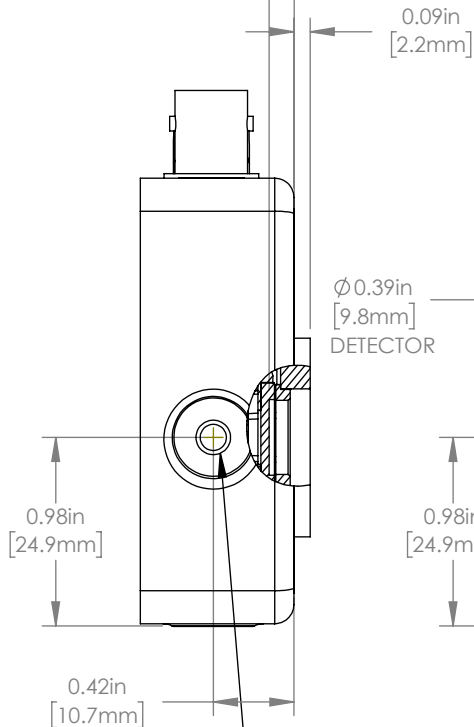

Ø0.39in [9.8mm]
DETECTOR

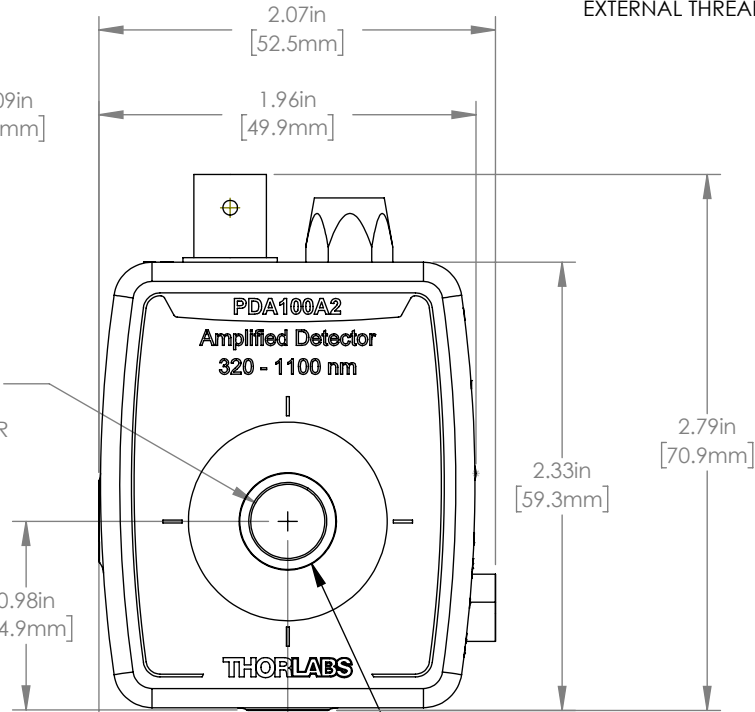

SM05 (0.535-40) SERIES INTERNAL THREAD

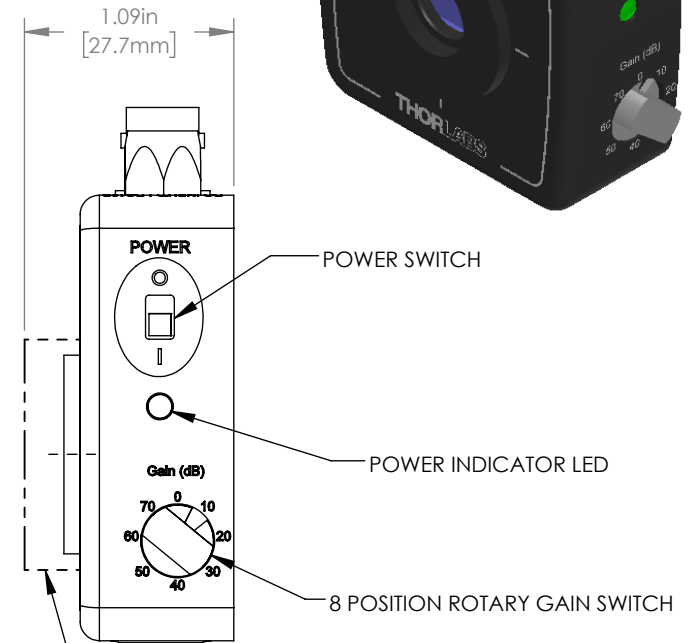

INCLUDED:
SM1 ADAPTER and
SM1RR RETAINING RING

THREAD MOUNTS ACCEPT:
8-32 x 0.25in
AND M4 x 0.7 x 6mm

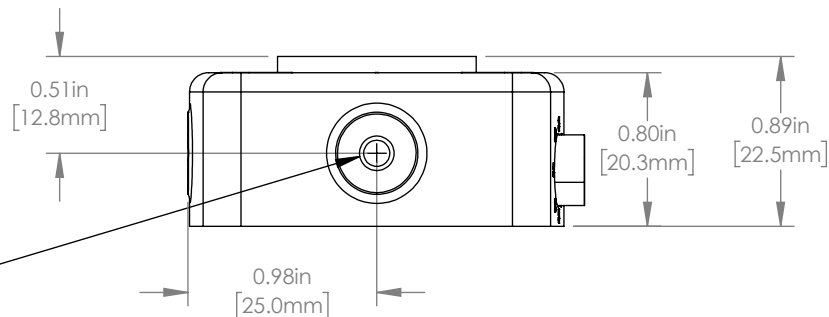

FOR INFORMATION ONLY
NOT FOR MANUFACTURING PURPOSES

DRAWING PROJECTION



	NAME	DATE
DRAWN	WKC	08/DEC/17
APPROVAL	RH	08/DEC/17

COPYRIGHT © 2017 BY THORLABS

VALUES IN PARENTHESIS ARE CALCULATED AND MAY CONTAIN ROUND OFF ERRORS

THORLABS
www.thorlabs.com

Si Adjustable Gain Detector

MATERIAL N/A REV B

ITEM # PDA100A2 APPROX WEIGHT 0.10 kg