

PART	PART NO.	MATERIAL
A	AC127-019-A1	BAFN10-SFL6
B	AC127-050-A1	BK7-SF2
C	LENS MOUNT	6061-T6 ALUMINUM
D	SM05RR	6061-T6 ALUMINUM

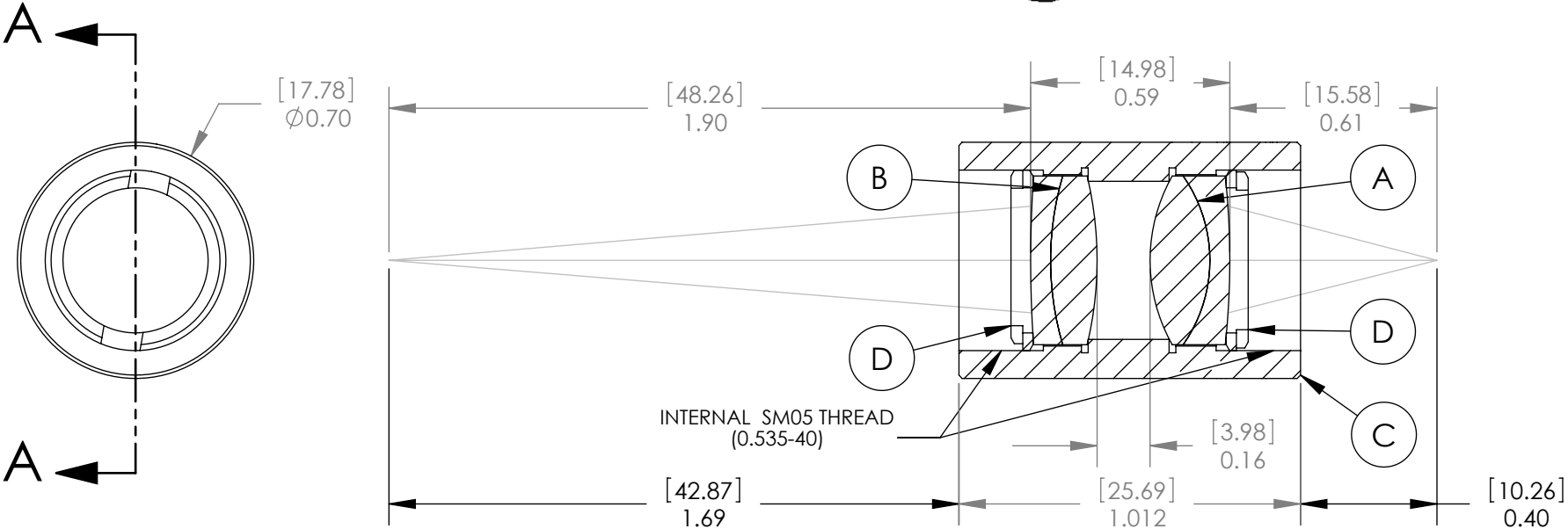

SECTION A-A

SPECIFICATIONS:
DESIGN WAVELENGTH: 486.1, 587.6 & 656.3nm
COATING: BBAR 400-700nm
COATING RANGE: R(AVG)<0.5% FROM 400-700nm
MAGNIFICATION: 1:2.63

Dimensions are in $\frac{[mm]}{in}$

NOTE:
FOR INFORMATION ONLY. NOT INTENDED FOR MANUFACTURING.

THORLABS INC. PO BOX 366
NEWTON NJ

TITLE: MATCHED ACHROMAT PAIR
F1=19mm, F2=50mm

MATERIAL: SEE TABLE
SIZE A REV. C

SCALE: 1:1 SHEET 1 OF 1

DWG. NO. 13313-E01
PART NO. MAP051950-A1

	NAME	DATE
DRAWN	AP	04/14/06
ENG APPR.	TO	04/14/06
MFG APPR.	TO	04/14/06

PROPRIETARY AND CONFIDENTIAL
THE INFORMATION CONTAINED IN THIS
DRAWING IS THE SOLE PROPERTY OF
THORLABS, INC. ANY REPRODUCTION
IN PART OR AS A WHOLE WITHOUT
THE WRITTEN PERMISSION OF
THORLABS, INC. IS PROHIBITED.