

NOTES:

1. SUBSTRATE: FUSED SILICA (CORNING 7980)
2. COATING (APPLY ACROSS CLEAR APERTURE)
 S1 & S2: R(ABS) ≤0.25% @ 880nm
 R(AVG) ≤1.25% FROM 400 - 870nm
 R(AVG) ≤1.25% FROM 890 - 1000nm
3. SURFACE S2 TO BE PARALLEL WITH SURFACE S1 WITHIN <10 ARCSEC

4. FINE GRIND SURFACE

5. ROHS COMPLIANT

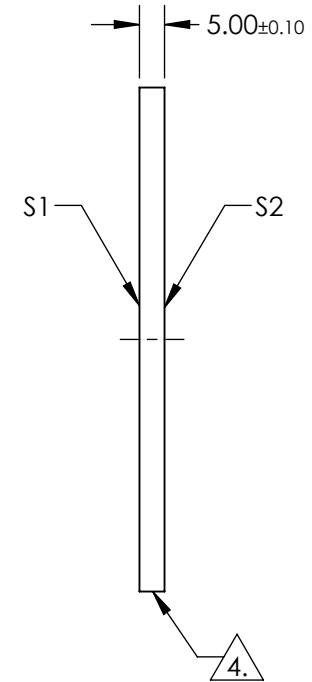
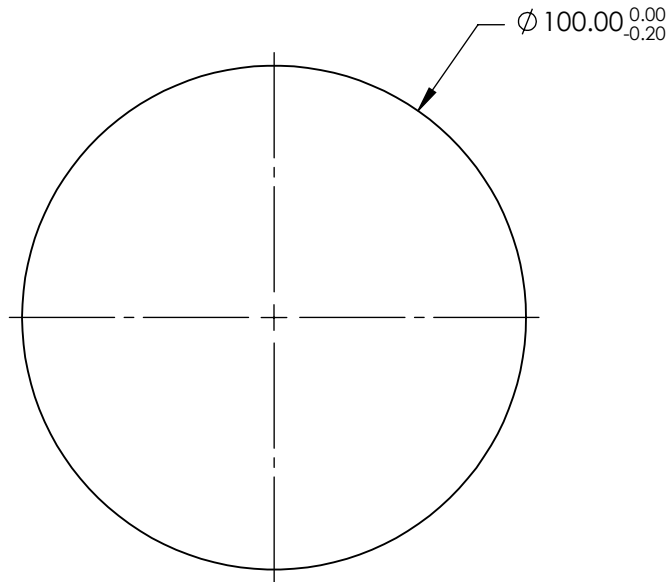

**FOR INFORMATION ONLY:
DO NOT MANUFACTURE
PARTS TO THIS DRAWING**

SPECIFICATIONS SUBJECT TO CHANGE WITHOUT NOTICE
DIMENSIONS ARE FOR REFERENCE ONLY

	S1	S2
SHAPE	PLANO	PLANO
SURFACE QUALITY	40-20	40-20
CLEAR APERTURE	Ø 90.00	Ø 90.00
BEVEL	PROTECTED AS NEEDED	PROTECTED AS NEEDED



ALL DIMS IN mm

EO® Edmund Optics®

TITLE 100mm Dia., 5mm Thick, VIS-NIR Coated λ/10 Fused Silica Window

DWG NO 22070

SHEET 1 OF 1