

NOTES:

1. SUBSTRATE:
FUSED SILICA (CORNING 7980)
2. S2 TO BE PARALLEL WITH S1 TO WITHIN <1' ARCMIN
3. COATING (APPLY ACROSS CLEAR APERTURE)
S1 & S2: R(AVG) ≤0.5% @ 600 - 1050nm
4. FINE GRIND SURFACE
5. ROHS COMPLIANT

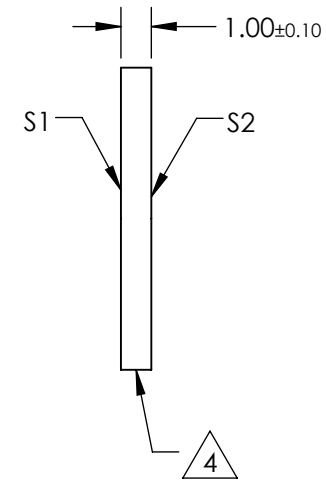
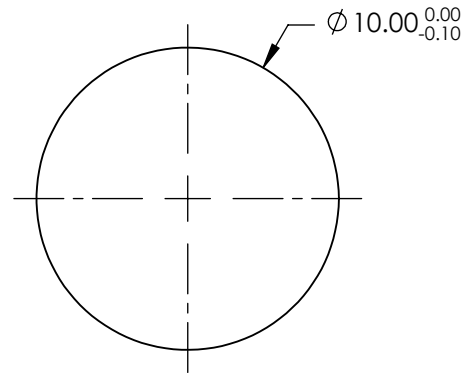
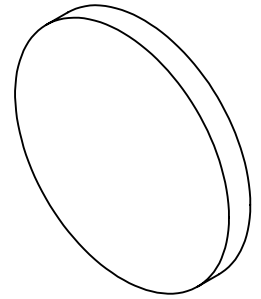

**FOR INFORMATION ONLY:
DO NOT MANUFACTURE
PARTS TO THIS DRAWING**

SPECIFICATIONS SUBJECT TO CHANGE WITHOUT NOTICE
DIMENSIONS ARE FOR REFERENCE ONLY

	S1	S2						
SHAPE	PLANO	PLANO						
SURFACE QUALITY	40-20	40-20	ALL DIMS IN mm	TITLE	10mm Dia., 1mm Thick, NIR I Coated, λ/4 Fused Silica Window			
CLEAR APERTURE (mm)	Ø9.00	Ø9.00						
BEVEL	PROTECTIVE AS NEEDED	PROTECTIVE AS NEEDED	DWG NO	18334	SHEET 1 OF 1			