

OUTPUT BNC WITH
0 - 2.0V RANGE

POWER INPUT CONNECTOR
LUMBERG RKM F 3/0.5M

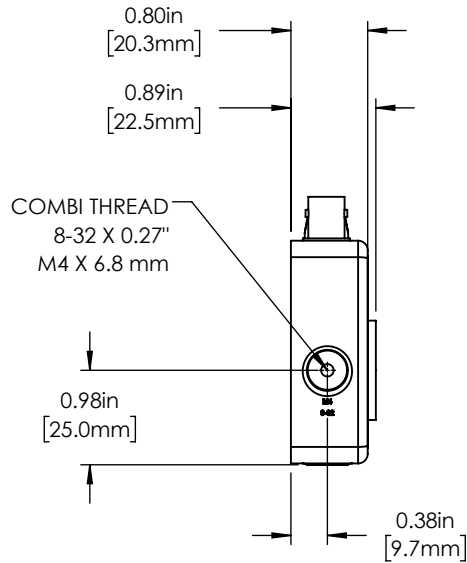

COMBI THREAD
8-32 X 0.27"
M4 X 6.8 mm

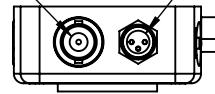
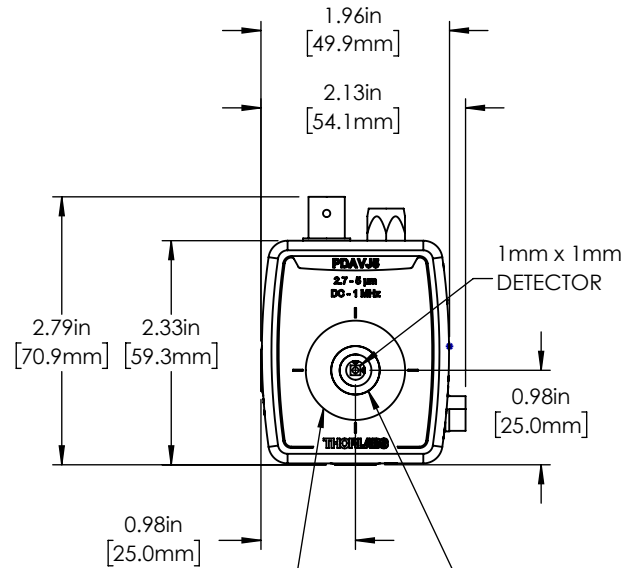

SM1 (1.035-40) EXTERNAL THREAD 2.1mm
(0.085") DEPTH

1mm x 1mm
DETECTOR

SM05 (0.535-40) INTERNAL THREAD 1.9mm
(0.076") DEPTH

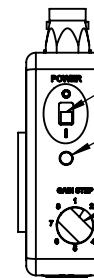

POWER SWITCH

POWER INDICATOR
LED

ROTARY GAIN SWITCH
8 POSITIONS

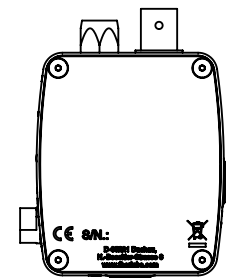

ELECTRICAL CONNECTIONS

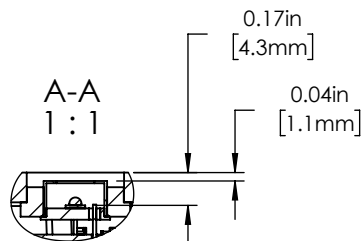

A-A
1:1

COMBI THREAD
8-32 X 0.27"
M4 X 6.8 mm

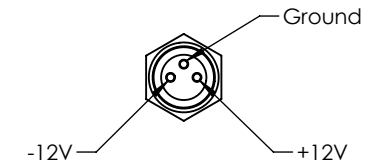
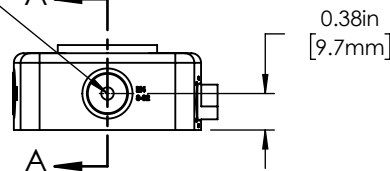

FOR INFORMATION ONLY
NOT FOR MANUFACTURING PURPOSES

DRAWING PROJECTION



	NAME	DATE
DRAWN	MUR	16/07/18
APPROVAL	ARU	17/07/18

COPYRIGHT © 2018 BY THORLABS

VALUES IN PARENTHESIS ARE CALCULATED
AND MAY CONTAIN ROUND OFF ERRORS

THORLABS
www.thorlabs.com

MCT AMPLIFIED DETECTOR

MATERIAL	REV
N/A	A

ITEM #	APPROX WEIGHT
PDAVJ5	80 g