

DIMENSIONS MAY DIFFER  
DUE TO INDIVIDUAL  
ALIGNMENT TO CAMERA

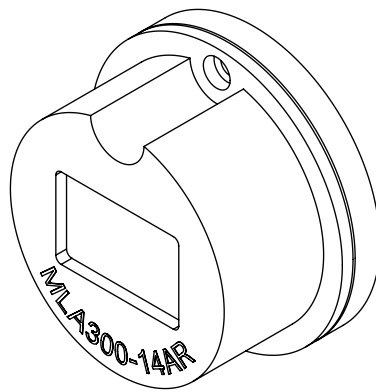
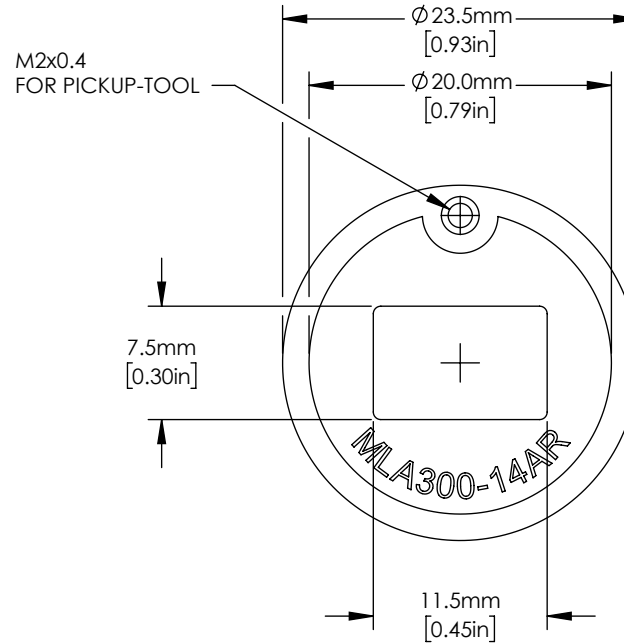

FOR INFORMATION ONLY  
NOT FOR MANUFACTURING PURPOSES

SUBSTRATE MATERIAL	FUSED SILICIA (QUARTZ)
WAVELENGTH RANGE	400 - 900nm
REFLECTANCE	<1% (400 - 900nm)
LENSLET TYPE	SQUARE GRID
LENSLET PITCH	300µm
LENSLET DIAMETER / SHAPE	300µm / SQUARE
CHROME APERTURES	NO
NOMINAL FOCAL LENGTH	18.6mm
EFFECTIVE FOCAL LENGTH (TYP. WHEN MOUNTED IN WFS)	14.6mm
ARRAY SIZE	12 x 12 x 1.2mm
CLEAR APERTURE (W x H)	11.5 x 7.5mm

DRAWING PROJECTION			 <a href="http://www.thorlabs.com">www.thorlabs.com</a>	
NAME	DATE			
DRAWN	Hit.	24/APR/17	MOUNTED MICROLENS ARRAY	
APPROVAL	EK	24/APR/17	MATERIAL	REV
COPYRIGHT © 2017 BY THORLABS			N.A.	A
VALUES IN PARENTHESIS ARE CALCULATED AND MAY CONTAIN ROUND OFF ERRORS			ITEM #	APPROX WEIGHT
			MLA300-14AR-W30	6 g