

	PART DESCRIPTION	MATERIAL
①	SM2RR	ANODIZED ALUMINUM
②	LA1301-C	N-BK7
③	ENGRAVED HOUSING	ANODIZED ALUMINUM

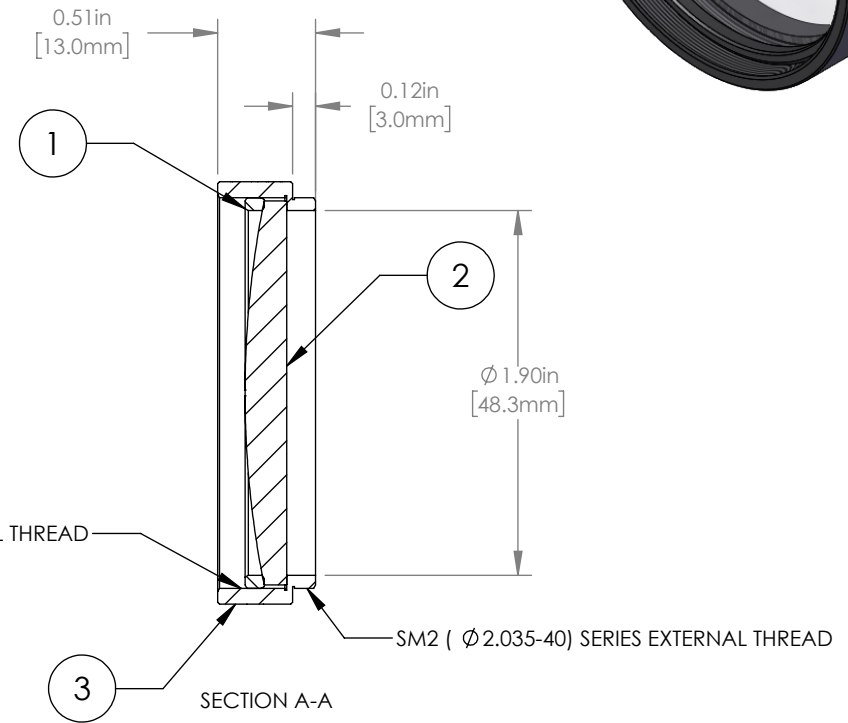
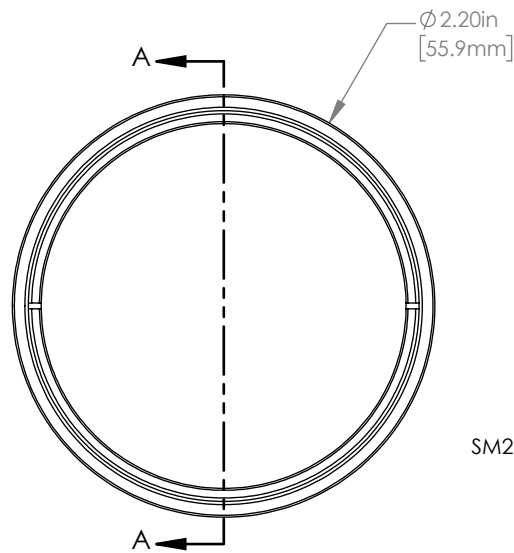

NOTES/SPECIFICATIONS:

- DESIGN WAVELENGTH: 587.6 nm
- FOCAL LENGTH: $f=249.2\text{ mm} \pm 1\%$
- WORKING DISTANCE (REF): 241.7 mm
- CLEAR APERTURE: $\phi 45.7\text{ mm}$
- SURFACE QUALITY: 40-20 SCRATCH-DIG
- COATING: BBAR $R_{\text{avg}} < 0.5\%$ FROM 1050-1700 nm, 0° AOI, ON BOTH OPTICAL SURFACES

FOR INFORMATION ONLY
NOT FOR MANUFACTURING PURPOSES

DRAWING PROJECTION						THORLABS www.thorlabs.com	
	NAME		DATE	MOUNTED $\phi 2"$ $f=250\text{ mm}$			
DRAWN	GG		20/JAN/20	PLANO CONVEX LENS, -C COATED			
APPROVAL	DD		20/JAN/20	MATERIAL			REV
COPYRIGHT © 2020 BY THORLABS				SEE TABLE			A
VALUES IN PARENTHESIS ARE CALCULATED AND MAY CONTAIN ROUND OFF ERRORS				ITEM #		APPROX WEIGHT	
				LA1301-C-ML		36 g	