

	PART DESCRIPTION	MATERIAL
①	SM2RR	ANODIZED ALUMINUM
②	LA4745-UV	UV FUSED SILICA
③	ENGRAVED HOUSING	ANODIZED ALUMINUM

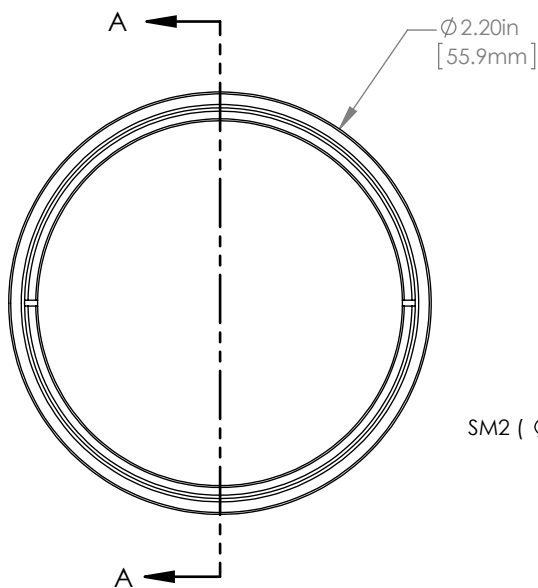

SM2 (ϕ 2.035-40) SERIES INTERNAL THREAD

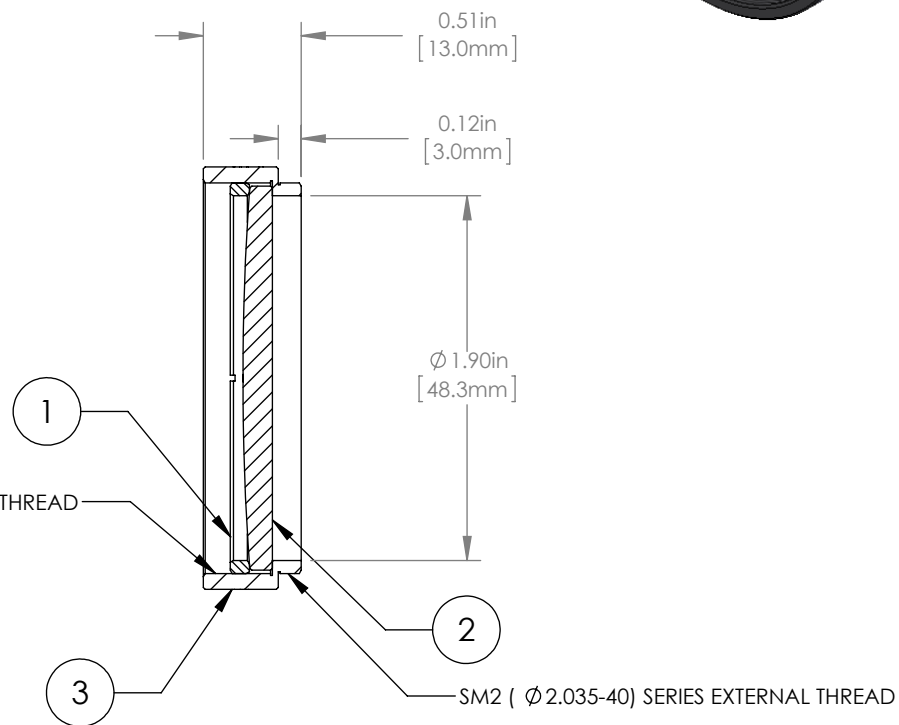

NOTES/SPECIFICATIONS:

- DESIGN WAVELENGTH: 546nm
- FOCAL LENGTH: $f=750.0\text{mm} \pm 1\%$
- WORKING DISTANCE (REF): 743.5mm
- CLEAR APERTURE: $> \phi 45.72\text{mm}$
- SURFACE QUALITY: 40-20 SCRATCH-DIG
- COATING: BBAR $R_{\text{avg}} < 0.5\%$ FROM 245-400nm, AOI: 0° , ON OUTER OPTICAL SURFACES

FOR INFORMATION ONLY
NOT FOR MANUFACTURING PURPOSES

DRAWING PROJECTION			THORLABS www.thorlabs.com	
NAME	DATE	ϕ 2" MOUNTED PLANO-CONVEX LENS, $f=750\text{mm}$, -UV COAT		
DRAWN	GG	13/OCT/15	MATERIAL	SEE TABLE
APPROVAL	DD	13/OCT/15	ITEM #	LA4745-UV-ML
COPYRIGHT © 2015 BY THORLABS			APPROX WEIGHT	29 g
VALUES IN PARENTHESIS ARE CALCULATED AND MAY CONTAIN ROUND OFF ERRORS			REV	A