

	PART DESCRIPTION	MATERIAL
①	SM3RR	ANODIZED ALUMINUM
②	LA4795	UV FUSED SILICA
③	ENGRAVED HOUSING	ANODIZED ALUMINUM

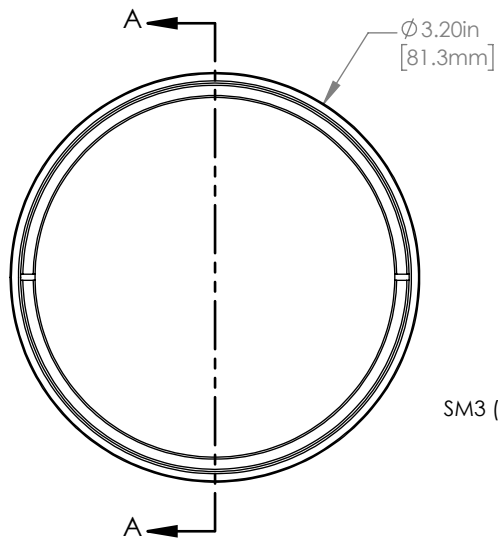

SM3 ($\phi 3.035\text{-}40$) SERIES INTERNAL THREAD

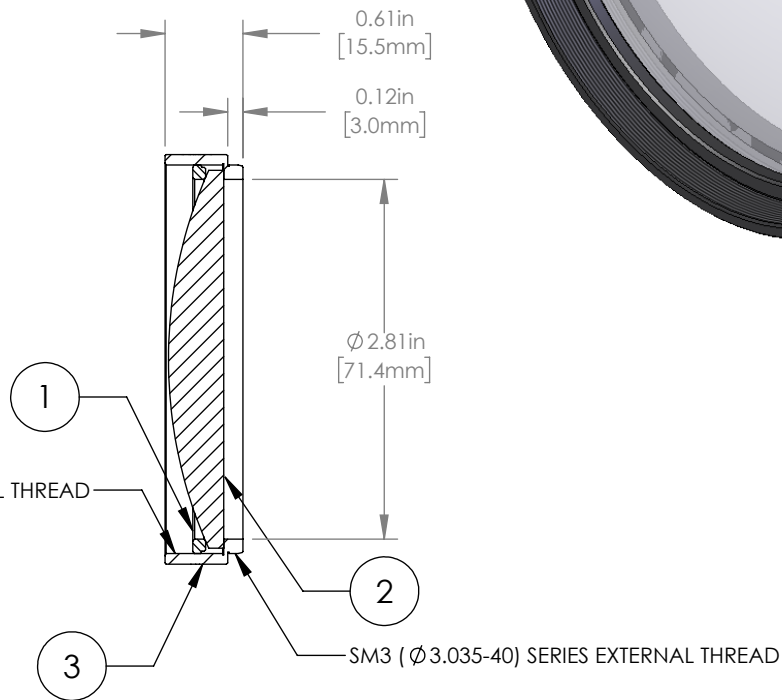

NOTES/SPECIFICATIONS:

- DESIGN WAVELENGTH: 546nm
- FOCAL LENGTH: $f=200.0\text{mm} \pm 1\%$
- WORKING DISTANCE (REF): 188.7mm
- CLEAR APERTURE: $> \phi 67.50\text{mm}$
- SURFACE QUALITY: 40-20 SCRATCH-DIG

FOR INFORMATION ONLY
 NOT FOR MANUFACTURING PURPOSES

DRAWING PROJECTION			THORLABS www.thorlabs.com	
NAME	DATE	$\phi 75.0\text{mm}$ MOUNTED PLANO-CONVEX LENS, $f=200\text{mm}$		
DRAWN	GG	13/OCT/15	MATERIAL	SEE TABLE
APPROVAL	DD	13/OCT/15	ITEM #	LA4795-ML
COPYRIGHT © 2015 BY THORLABS			APPROX WEIGHT	94 g
VALUES IN PARENTHESIS ARE CALCULATED AND MAY CONTAIN ROUND OFF ERRORS			REV	A