

NOTES:

1. SUBSTRATE:  
FLOAT GLASS
2. ANTI REFLECTION SURFACE TREATMENT (APPLY ACROSS CLEAR APERTURE)  
AOI: 0°  
S1 & S2: Ravg ≤0.5% @ 425 - 700nm

3. GROUND EDGES

4. ROHS COMPLIANT

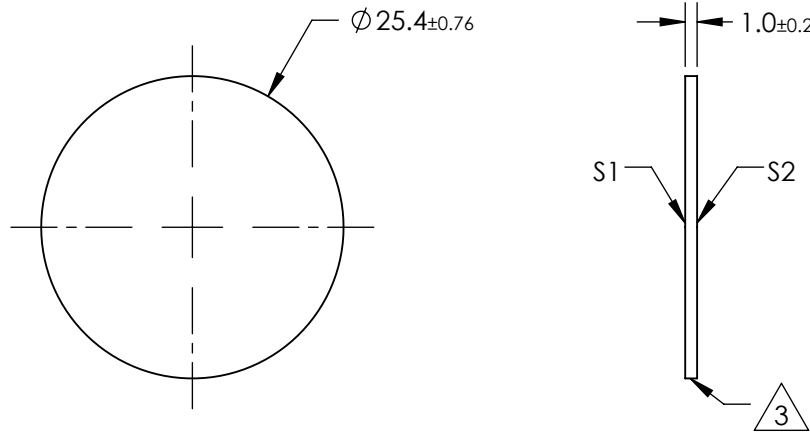
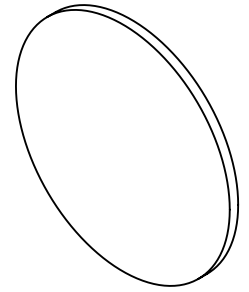

**FOR INFORMATION ONLY:  
DO NOT MANUFACTURE  
PARTS TO THIS DRAWING**

SPECIFICATIONS SUBJECT TO CHANGE WITHOUT NOTICE  
DIMENSIONS ARE FOR REFERENCE ONLY

	S1	S2
SHAPE	PLANO	PLANO
SURFACE QUALITY	80-50	80-50
CLEAR APERTURE	≥90%	≥90%
BEVEL	PROTECTIVE AS NEEDED	PROTECTIVE AS NEEDED

THIRD ANGLE PROJECTION

ALL DIMS IN mm

**EO**® Edmund Optics®

TITLE Ø25.4mm x 1mm HIGH EFFICIENCY WINDOW

DWG NO 48924

SHEET 1 OF 1