

NOTES:

1. SUBSTRATE:
NITROCELLULOSE
2. COATING (APPLY ACROSS CLEAR APERTURE)

 S1: DIELECTRIC
 50% R @ nm @ 45° AOI
 50% T @ nm @ 45° AOI
 R/T TOLERANCE: ±3%
 S2: NONE
3. ROHS COMPLIANT

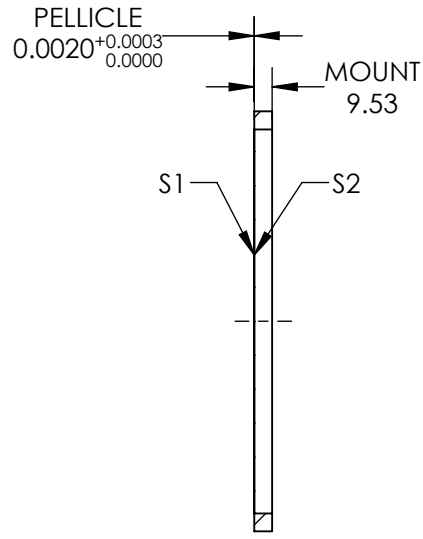
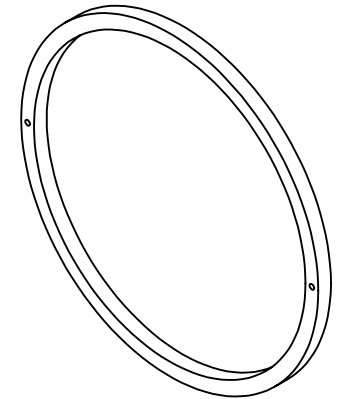

SECTION A-A

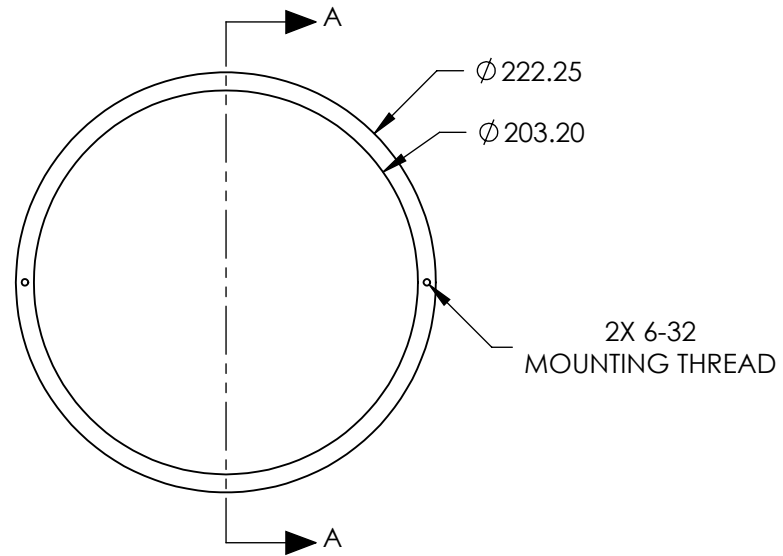

**FOR INFORMATION ONLY:
DO NOT MANUFACTURE
PARTS TO THIS DRAWING**

SPECIFICATIONS SUBJECT TO CHANGE WITHOUT NOTICE
DIMENSIONS ARE FOR REFERENCE ONLY

	S1	S2
SHAPE	PLANO	PLANO
SURFACE QUALITY	40-20	40-20
CLEAR APERTURE	Ø 203.2	Ø 203.2
BEVEL	PROTECTED AS NEEDED	PROTECTED AS NEEDED



ALL DIMS IN

mm

EO® **Edmund Optics**®

TITLE

203.2mm Clear Aperture 50R/50T, Pellicle
Beamsplitter

DWG NO

19311

SHEET
1 OF 1