

NOTES:

1. SUBSTRATE:  
N-BK7
2. S2 TO BE PARALLEL TO S1 TO WITHIN <1 ARCMIN
3. COATING (APPLY ACROSS COATING APERTURE)  
S1 & S2: NIR I (600-1050nm)  
R(AVG) ≤0.5% @ 600 - 1050nm
4. FINE GRIND SURFACE
5. ROHS COMPLIANT

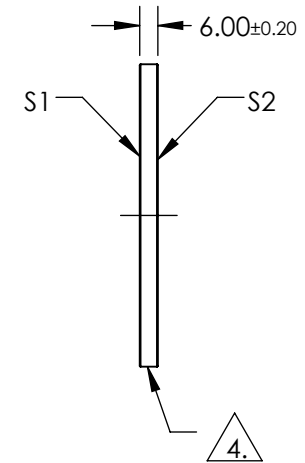
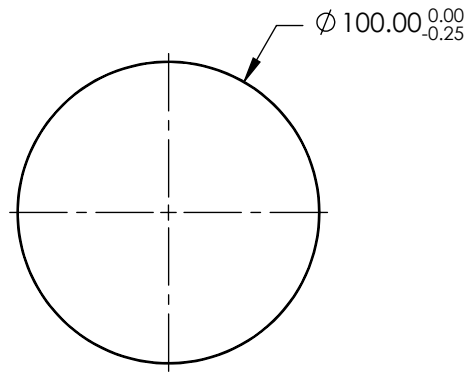
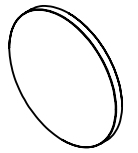

**FOR INFORMATION ONLY:  
DO NOT MANUFACTURE  
PARTS TO THIS DRAWING**

SPECIFICATIONS SUBJECT TO CHANGE WITHOUT NOTICE  
DIMENSIONS ARE FOR REFERENCE ONLY

	S1	S2	Edmund Optics®			
SHAPE	PLANO	PLANO				
SURFACE QUALITY	60-40	60-40	THIRD ANGLE PROJECTION	TITLE	100mm DIA., 6mm THICK, NIR I COATED λ/4 N-BK7 WINDOW	
WAVELENGTH RANGE	600 - 1050 nm	600 - 1050 nm		ALL DIMS IN	mm	DWG NO
BEVEL	PROTECTIVE AS NEEDED	PROTECTIVE AS NEEDED				SHEET 1 OF 1