

$\phi 0.09"$  ( $\phi 2.3\text{mm}$ ) HOLE  
FOR USE WHEN LOCKING/UNLOCKING  
4 PLACES

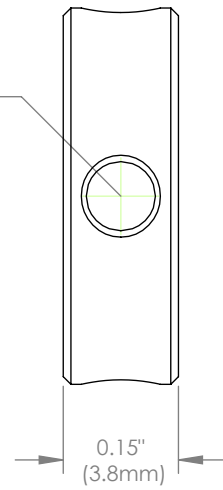

**THORLABS INC.** PO BOX 366  
NEWTON NJ

	NAME	DATE
DRAWN	BG	11/07/08
ENG APPR.	BG	11/07/08
MFG APPR.	BG	11/07/08

TITLE: 3/16"-100 LOCKING NUT

MATERIAL: BRONZE SIZE A REV. A

SCALE: 4:1 SHEET 1 OF 1

DWG. NO. 18896-E01 PART NO. LN19100

**PROPRIETARY AND CONFIDENTIAL**  
THE INFORMATION CONTAINED IN THIS  
DRAWING IS THE SOLE PROPERTY OF  
THORLABS, INC. ANY REPRODUCTION  
IN PART OR AS A WHOLE WITHOUT  
THE WRITTEN PERMISSION OF  
THORLABS, INC. IS PROHIBITED.