

	PART DESCRIPTION	MATERIAL
①	SM2RR	ANODIZED ALUMINUM
②	LA1301-A	N-BK7
③	ENGRAVED HOUSING	ANODIZED ALUMINUM

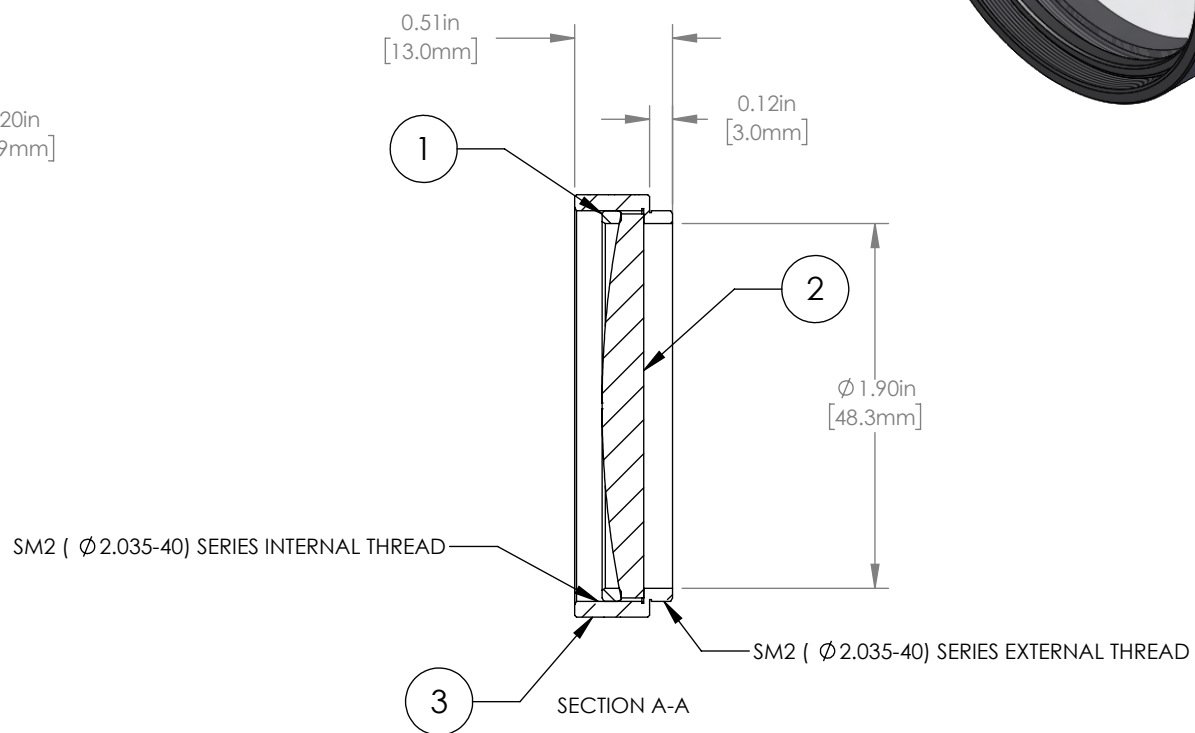
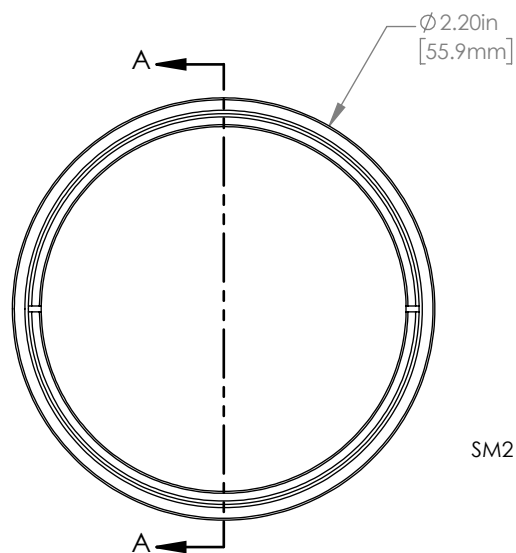

NOTES/SPECIFICATIONS:

- DESIGN WAVELENGTH: 587.6 nm
- FOCAL LENGTH:  $f=249.2 \text{ mm} \pm 1\%$
- WORKING DISTANCE (REF): 241.7 mm
- CLEAR APERTURE: Ø 45.7 mm
- SURFACE QUALITY: 40-20 SCRATCH-DIG
- COATING: BBAR  $R_{avg} < 0.5\%$  FROM 350-700 nm, 0° AOI, ON BOTH OPTICAL SURFACES

FOR INFORMATION ONLY  
NOT FOR MANUFACTURING PURPOSES

DRAWING PROJECTION						<b>THORLABS</b> www.thorlabs.com	
NAME	DATE	MOUNTED Ø 2" f=250 mm				REV	
DRAWN GG	20/JAN/20	PLANO CONVEX LENS, -A COATED				A	
APPROVAL DD	20/JAN/20	MATERIAL SEE TABLE					
COPYRIGHT © 2020 BY THORLABS				ITEM #		APPROX WEIGHT	
VALUES IN PARENTHESIS ARE CALCULATED AND MAY CONTAIN ROUND OFF ERRORS				LA1301-A-ML		36 g	