

NOTES:

1. SUBSTRATE: FUSED SILICA
2. BEAM MODE: SM OR MM
3. OVERALL EFFICIENCY: 92%
4. RING ANGLE: 1.35°
5. ZERO ORDER, RELATIVE TO THE INCIDENT BEAM: <1%
6. COATING:  
LASER V-COAT(1064nm)
7. BEAM SPECIFICATION:  
MINIMUM BEAM DIAMETER: 0.27mm

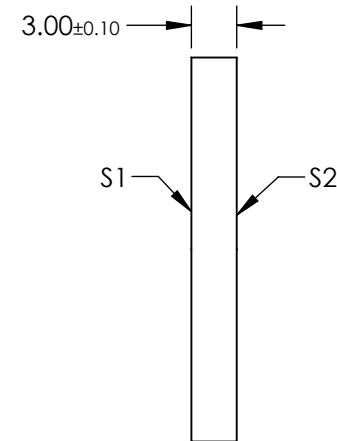
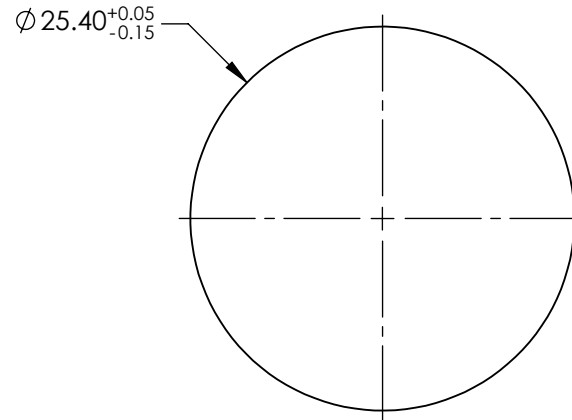

**FOR INFORMATION ONLY:  
DO NOT MANUFACTURE  
PARTS TO THIS DRAWING**

SPECIFICATIONS SUBJECT TO CHANGE WITHOUT NOTICE  
DIMENSIONS ARE FOR REFERENCE ONLY

**EO**® Edmund Optics®

	S1	S2	THIRD ANGLE PROJECTION		TITLE	1064nm, 25.4mm DIA., DIFFRACTIVE AXICON	
SHAPE	PLANO	PLANO	ALL DIMS IN	mm	DWG NO	14678	SHEET 1 OF 1
MIN CLEAR APERTURE	Ø22.9mm	Ø22.9mm					
BEVEL MAX FACE	PROTECTIVE AS NEEDED	PROTECTIVE AS NEEDED					