

	PART DESCRIPTION	MATERIAL
①	SM3RR	ANODIZED ALUMINUM
②	LA4246	UV FUSED SILICA
③	ENGRAVED HOUSING	ANODIZED ALUMINUM

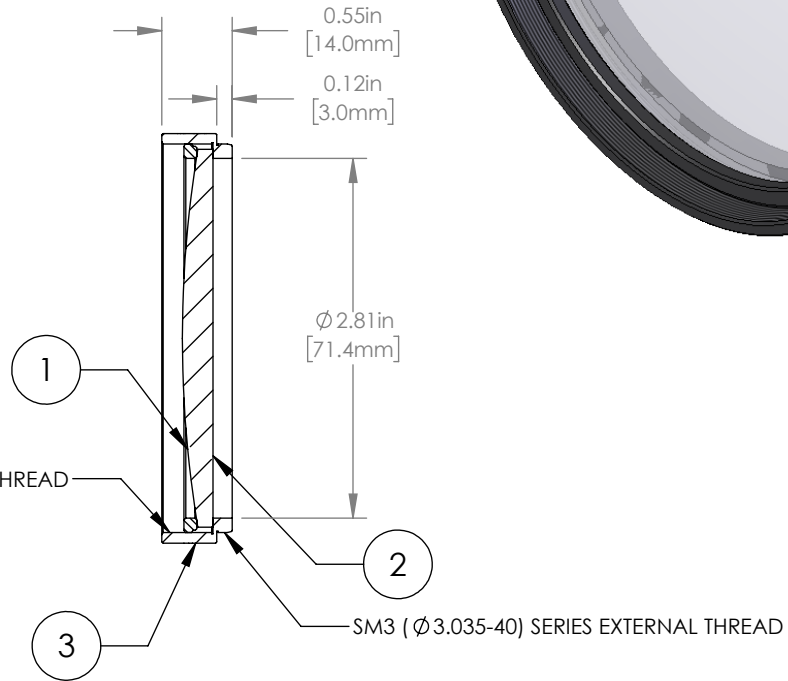
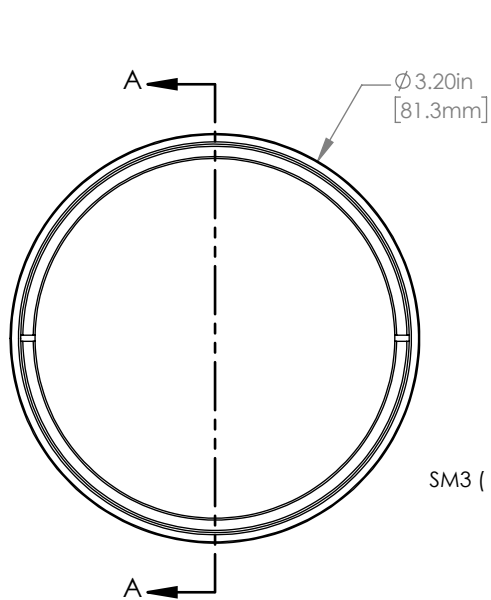

NOTES/SPECIFICATIONS:

1. DESIGN WAVELENGTH: 546nm
2. FOCAL LENGTH: $f=500.0\text{mm} \pm 1\%$
3. WORKING DISTANCE (REF): 492.0mm
4. CLEAR APERTURE: $> \text{Ø } 67.50\text{mm}$
5. SURFACE QUALITY: 40-20 SCRATCH-DIG

FOR INFORMATION ONLY
NOT FOR MANUFACTURING PURPOSES

DRAWING PROJECTION		THORLABS www.thorlabs.com	
	NAME	DATE	Ø 75.0mm MOUNTED PLANO-CONVEX LENS, f=500mm
DRAWN	GG	13/OCT/15	
APPROVAL	DD	13/OCT/15	
COPYRIGHT © 2015 BY THORLABS			MATERIAL SEE TABLE
VALUES IN PARENTHESIS ARE CALCULATED AND MAY CONTAIN ROUND OFF ERRORS			ITEM # LA4246-ML
			APPROX WEIGHT 67 g