

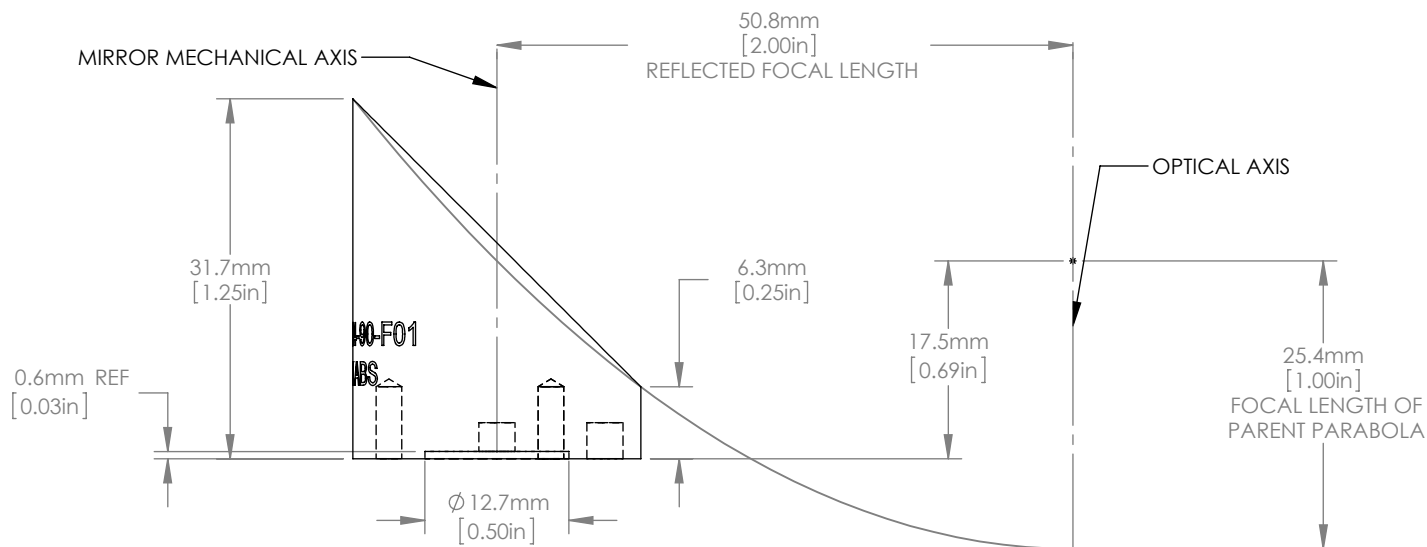

1:1 ISOMETRIC VIEW

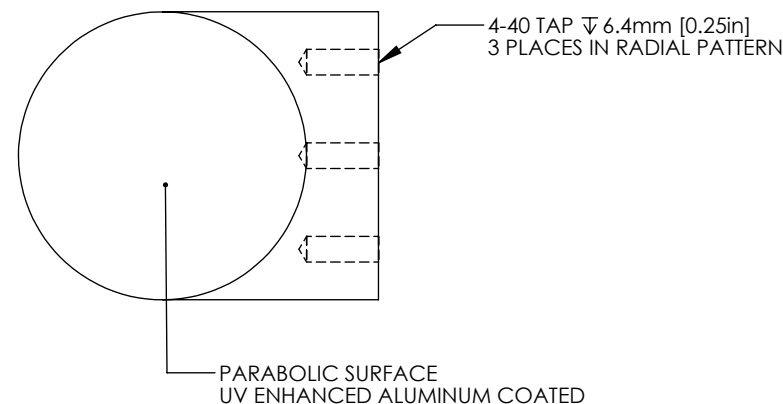

SCALE: 3:2

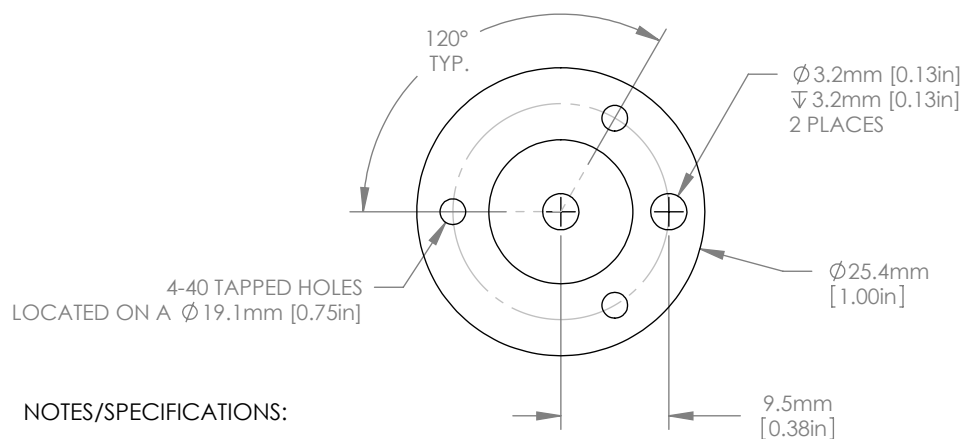

NOTES/SPECIFICATIONS:

1. PFL(PARENT FOCAL LENGTH): 25.4mm ±1%
2. REFLECTED FOCAL LENGTH: 50.8mm ±1%
3. CLEAR APERTURE: >90% OF DIAMETER
4. SURFACE IRREGULARITY: 0.25λ @ 633nm
5. SURFACE QUALITY: 40-20 SCRATCH-DIG
6. SURFACE ROUGHNESS: <100A RMS
7. COATING (PARABOLIC SURFACE): UV ENHANCED ALUMINUM
Ravg>90% FROM 250-450nm
8. BLACK ANODIZED FINISH (NON-OPTICAL SURFACES)

FOR INFORMATION ONLY
NOT FOR MANUFACTURING PURPOSES

DRAWING PROJECTION			 www.thorlabs.com Ø 25.4mm 90° OFF AXIS PARABOLA PFL=25.4mm, UV ENHANCED ALUMINUM	
NAME	DATE			
DRAWN	MG	25/JULY/12	MATERIAL	
APPROVAL	DD	30/JULY/12	6061-T6 ALUMINUM	
COPYRIGHT © 2012 BY THORLABS			ITEM #	APPROX WEIGHT
VALUES IN PARENTHESIS ARE CALCULATED AND MAY CONTAIN ROUND OFF ERRORS			MPD254254-90-F01	0.01 kg
			REV	A