

FDS100 Silicon Photodiode<sub>2</sub>  
 Active Area: 13 mm<sup>2</sup>  
 Range: 350-1100 nm  
 Anode Grounded

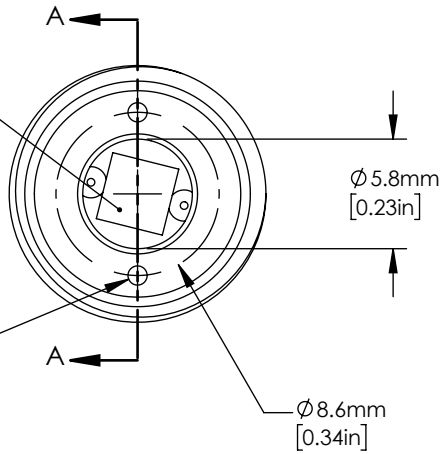

Use with Adjustable  
 Spanner Wrench

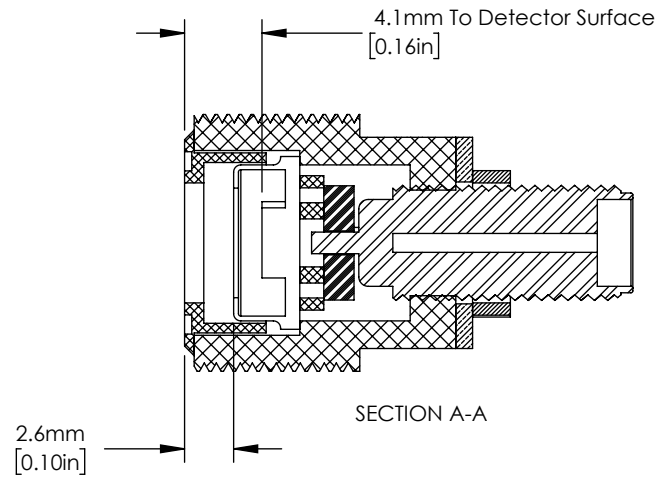

Housing  
 External Thread:  
 SM05 (0.535-40)  
 Material: Black DELRIN

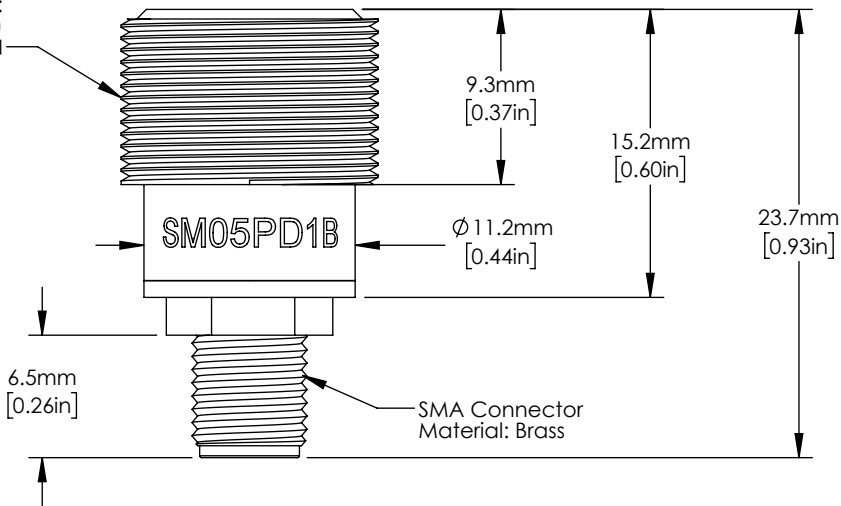

FOR INFORMATION ONLY  
 NOT FOR MANUFACTURING PURPOSES

DRAWING PROJECTION			<b>THORLABS</b> www.thorlabs.com	
NAME	DATE	SM05 Mounted Si-Photodiode		
WKC	29/MAR/18			
APPROVAL	EC	30/MAR/18	MATERIAL	REV
COPYRIGHT © 2018 BY THORLABS			See Drawing	D
VALUES IN PARENTHESIS ARE CALCULATED AND MAY CONTAIN ROUND-OFF ERRORS		ITEM #	APPROX WEIGHT	
		SM05PD1B	.005 kg	