

PART	PART NO.	MATERIAL
A	AC127-025-A1	BAF10-SF10
B	AC127-050-A1	BK7-SF2
C	LENS MOUNT	6061-T6 ALUMINUM
D	SM05RR	6061-T6 ALUMINUM

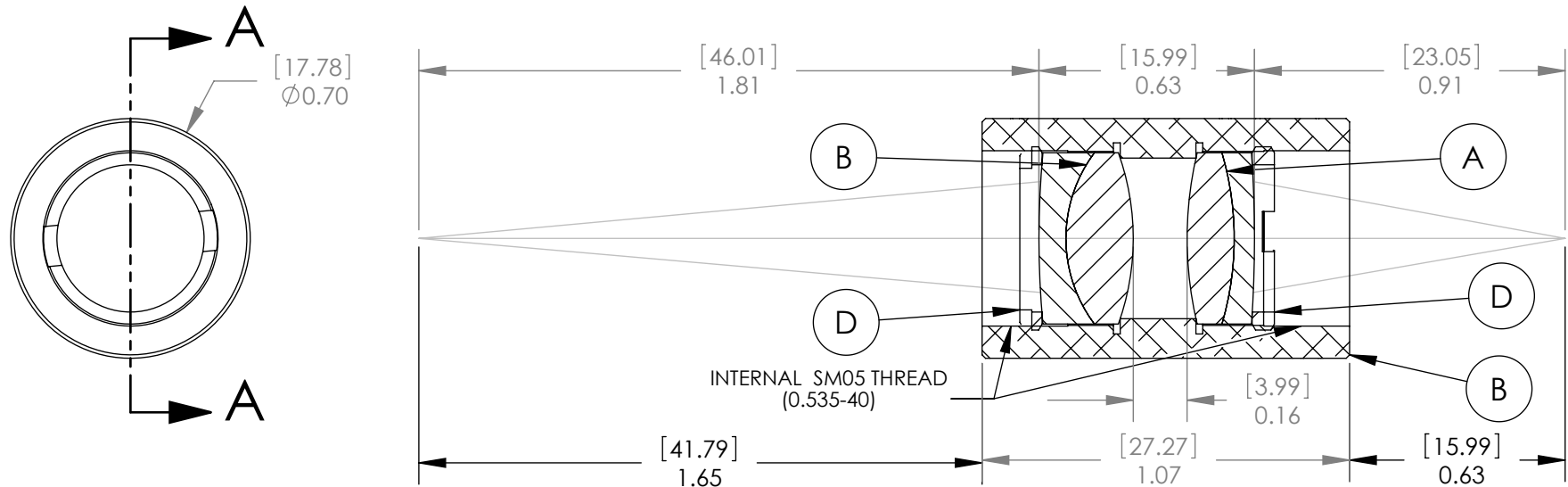

SECTION A-A

SPECIFICATIONS:

DESIGN WAVELENGTH: 486.1, 587.6 & 656.3nm
 COATING: BBAR 400-700nm
 COATING RANGE: R(AVG)<0.5% FROM 400-700nm
 MAGNIFICATION: 1:2

Dimensions are in $\frac{[mm]}{in}$

NOTE:
FOR INFORMATION ONLY. NOT INTENDED FOR MANUFACTURING.

THORLABS INC. PO BOX 366
NEWTON NJ

TITLE: MATCHED ACHROMAT PAIR
F1=25mm, F2=50mm

MATERIAL: SEE TABLE SIZE A REV. C

SCALE: 1:1 SHEET 1 OF 1

DWG. NO. 13316-E01 PART NO. MAP052550-A1

	NAME	DATE
DRAWN	AP	04/14/06
ENG APPR.	TO	04/14/06
MFG APPR.	TO	04/14/06

PROPRIETARY AND CONFIDENTIAL

THE INFORMATION CONTAINED IN THIS DRAWING IS THE SOLE PROPERTY OF THORLABS, INC. ANY REPRODUCTION IN PART OR AS A WHOLE WITHOUT THE WRITTEN PERMISSION OF THORLABS, INC. IS PROHIBITED.