

INFORMATION ONLY, NOT FOR MANUFACTURING

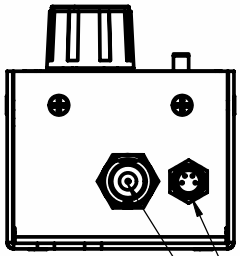

LED OUTPUT  
(4-PIN LUMBERG)  
MODULATION INPUT  
(BNC)

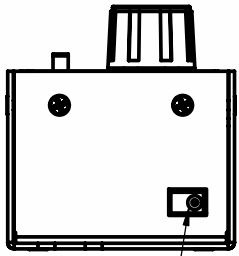
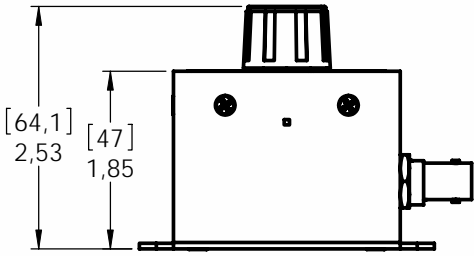

15VDC INPUT  
(3.5MM KOAX  
CENTER PLUS POLE)



MOUNTING HOLES FOR  
HUB OR BASEPLATE

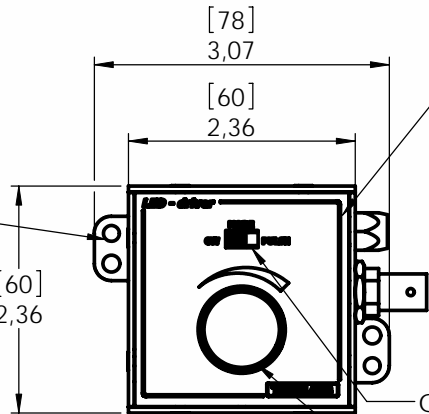

FRONT PANEL CAN BE  
ROTATED CLOCKWISE  
BY 90 DEGREES

OPERATING MODE SWITCH  
ON SWITCH / CURRENT ADJUSTMENT

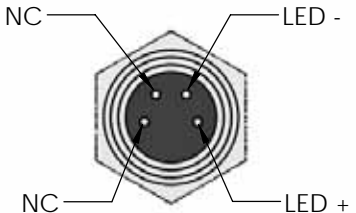

LED OUTPUT CONNECTOR

ALL DIMENSIONS IN PARANTHESES ARE MILLIMETERS

UNLESS OTHERWISE SPECIFIED:  
DIMENSIONS ARE IN INCHES  
TOLERANCES LINEAR: ±0.005  
ANGULAR: ±30'

DEBUR AND  
BREAK SHARP  
EDGES

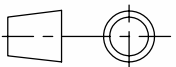

**THORLABS** Karlsfeld  
Germany

	NAME	DATE
DRAWN	Go	11/08/06
CHK'D	Go	11/08/06
APPV'D	Go	11/08/06

MATERIAL:  
N/A

TITLE:  
LED DRIVER

NO PART OF THIS DRAWING MAY BE  
REPRODUCED OR TRANSMITTED IN ANY  
FORM OR BY ANY MEANS INCLUDING  
PHOTOCOPYING OR RECORDING  
WITHOUT THE PRIOR WRITTEN  
PERMISSION OF THORLABS GMBH

FINISH / TREATMENT:  
N/A

PART NO. **LEDD1, LEDD1A** REV **A**  
DWG NO. **14194-E0W** SIZE **A4**