

TOP VIEW

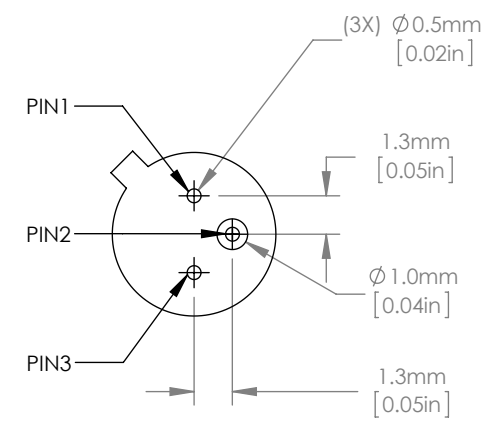

BOTTOM VIEW

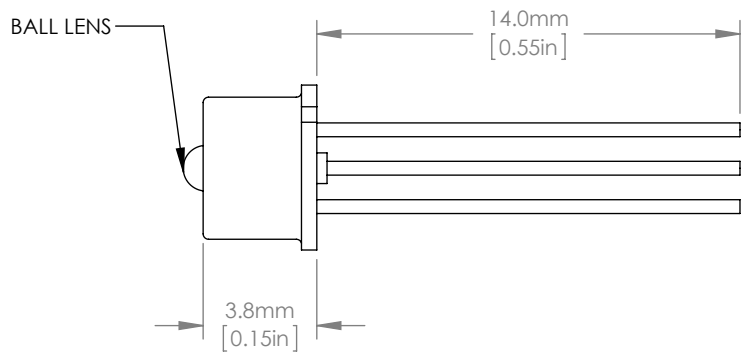
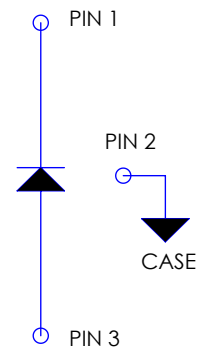

PIN CIRCLE DIAMETER = 2.5mm [0.10 in]

| | |
|--|---|
| | NOTICE |
| | <p>To avoid equipment damage from electrostatic discharge: Wear ESD wriststrap when handling this device.</p> |

FOR INFORMATION ONLY
NOT FOR MANUFACTURING PURPOSES

| | | | | |
|---|------|---------|-------------------------------------|---------------|
| DRAWING PROJECTION | | | THORLABS www.thorlabs.com | |
| | NAME | DATE | FDS025, SI HIGH SPEED PHOTODIODE | |
| DRAWN | DG | 6/27/14 | MATERIAL | |
| APPROVAL | DG | 6/27/14 | N/A | |
| COPYRIGHT © 2010 BY THORLABS | | | ITEM # | APPROX WEIGHT |
| VALUES IN PARENTHESIS ARE CALCULATED AND MAY CONTAIN ROUND OFF ERRORS | | | FDS025 | 0.02 kg |
| | | | REV | C |