

	PART DESCRIPTION	MATERIAL
①	SM2RR	ANODIZED ALUMINUM
②	LA1384-C	N-BK7
③	ENGRAVED HOUSING	ANODIZED ALUMINUM

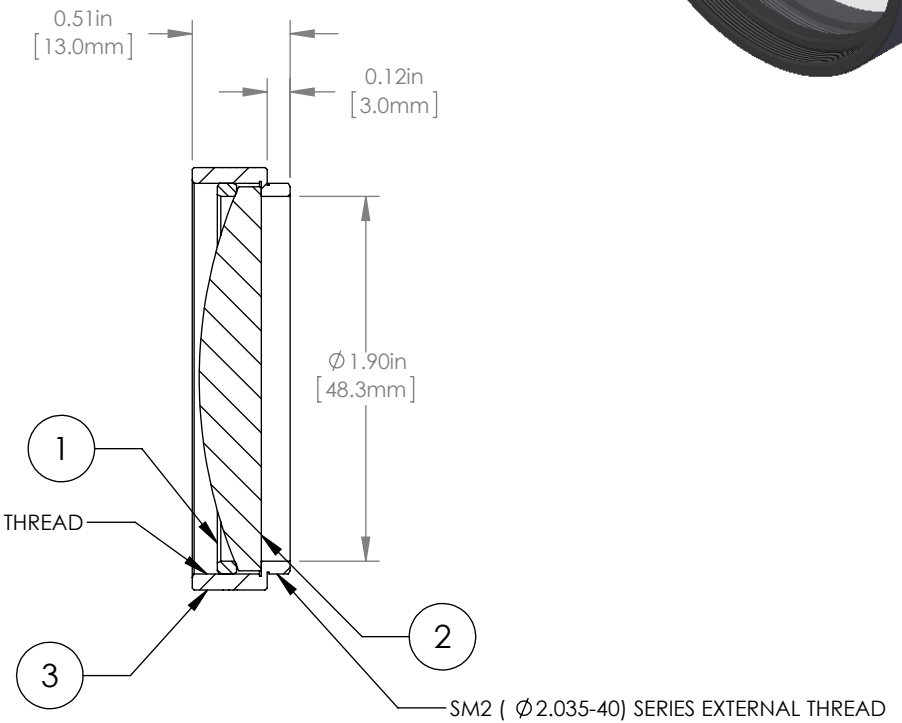
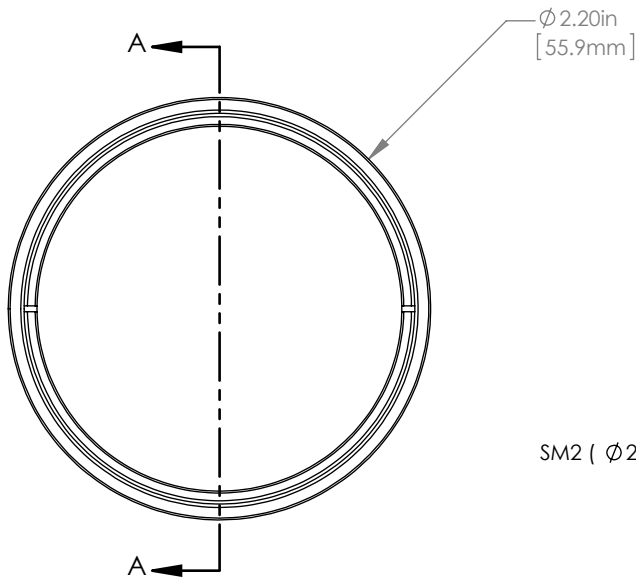

NOTES/SPECIFICATIONS:

- DESIGN WAVELENGTH: 633nm
- FOCAL LENGTH:  $f=125.0\text{mm} \pm 1\%$
- WORKING DISTANCE (REF): 115.8mm
- CLEAR APERTURE:  $> \phi 45.72\text{mm}$
- SURFACE QUALITY: 40-20 SCRATCH-DIG
- COATING: BBAR  $R_{\text{avg}} < 0.5\%$  FROM 1050-1700nm, AOI: 0°, ON OUTER OPTICAL SURFACES

FOR INFORMATION ONLY  
NOT FOR MANUFACTURING PURPOSES

DRAWING PROJECTION			THORLABS www.thorlabs.com	
	NAME	DATE	<b>Ø 2" MOUNTED PLANO-CONVEX LENS, <math>f=125\text{mm}</math>, -C COAT</b> MATERIAL SEE TABLE REV A	
DRAWN	GG	15/OCT/15		
APPROVAL	DD	15/OCT/15		
COPYRIGHT © 2015 BY THORLABS			ITEM #	APPROX WEIGHT
VALUES IN PARENTHESIS ARE CALCULATED AND MAY CONTAIN ROUND OFF ERRORS			LA1384-C-ML	42 g