

	PART DESCRIPTION	MATERIAL
①	SM2RR	ANODIZED ALUMINUM
②	LA1301-B	N-BK7
③	ENGRAVED HOUSING	ANODIZED ALUMINUM

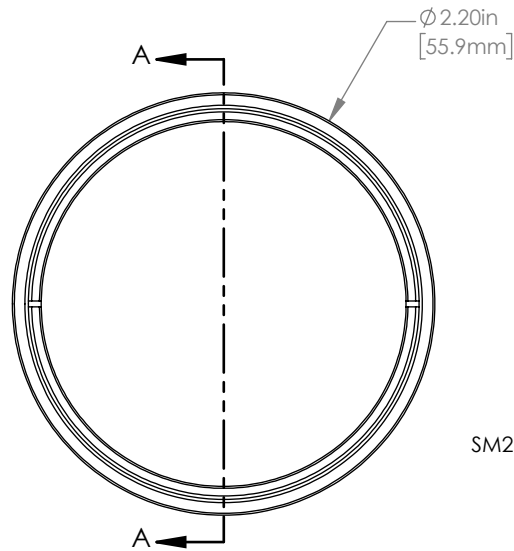

SM2 (  $\varnothing 2.035-40$  ) SERIES INTERNAL THREAD

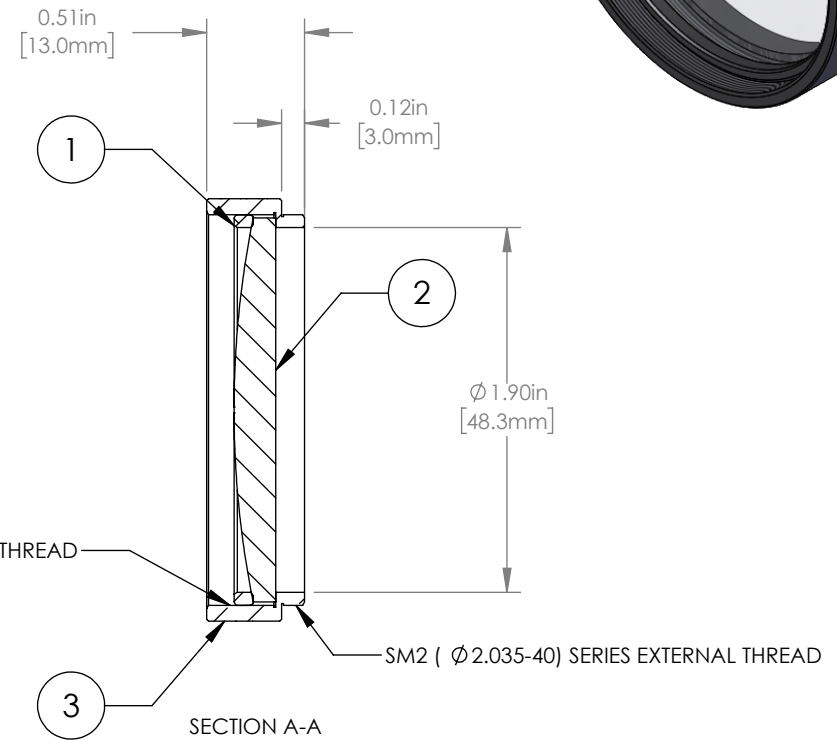

NOTES/SPECIFICATIONS:

- DESIGN WAVELENGTH: 587.6 nm
- FOCAL LENGTH:  $f=249.2\text{ mm} \pm 1\%$
- WORKING DISTANCE (REF): 241.7 mm
- CLEAR APERTURE:  $\varnothing 45.7\text{ mm}$
- SURFACE QUALITY: 40-20 SCRATCH-DIG
- COATING: BBAR  $R_{\text{avg}} < 0.5\%$  FROM 650-1050 nm,  $0^\circ$  AOI, ON BOTH OPTICAL SURFACES

FOR INFORMATION ONLY  
NOT FOR MANUFACTURING PURPOSES

DRAWING PROJECTION				<b>THORLABS</b> www.thorlabs.com	
	NAME	DATE	MOUNTED $\varnothing 2"$ $f=250\text{ mm}$		
DRAWN	GG	20/JAN/20	PLANO CONVEX LENS, -B COATED		
APPROVAL	DD	20/JAN/20	MATERIAL	SEE TABLE	REV A
COPYRIGHT © 2020 BY THORLABS			ITEM #	APPROX WEIGHT	
VALUES IN PARENTHESIS ARE CALCULATED AND MAY CONTAIN ROUND OFF ERRORS			LA1301-B-ML	36 g	