

NOTES:

1. SUBSTRATE:
FUSED SILICA
2. SURFACE S2 TO BE PARALLEL TO SURFACE S1 TO WITHIN <5 ARCSEC
3. COATING (APPLY ACROSS COATING APERTURE):
S1 & S2: NIR II (750-1550nm)
R(ABS) ≤1.5% @ 750 - 800nm
R(ABS) ≤1.0% @ 800 - 1550nm
R(AVG) ≤0.7% @ 750 - 1550nm
4. WAVELENGTH RANGE: 750 - 1550nm

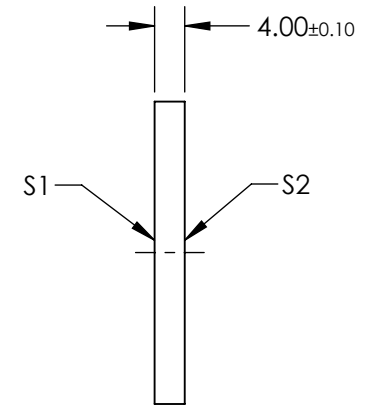
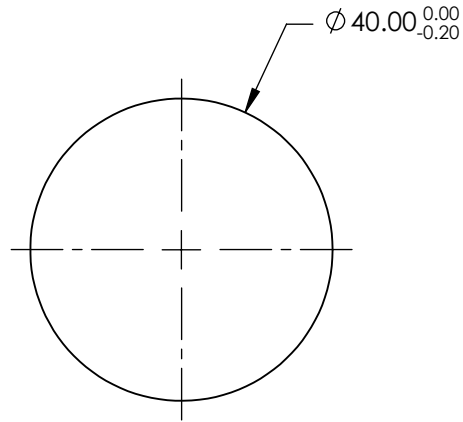

**FOR INFORMATION ONLY:
DO NOT MANUFACTURE
PARTS TO THIS DRAWING**

SPECIFICATIONS SUBJECT TO CHANGE WITHOUT NOTICE
DIMENSIONS ARE FOR REFERENCE ONLY

| | S1 | S2 | Edmund Optics® | | | | |
|-----------------------------|----------------------|----------------------|---|----|--------|-------|-----------------|
| SHAPE | PLANO | PLANO | <div style="display: flex; align-items: center;"> <div style="margin-right: 10px;"> <p>THIRD ANGLE PROJECTION</p> </div> <div> <p>TITLE</p> <p>40mm Dia., 4mm Thick, NIR II Coated λ/10 Fused Silica Window</p> </div> </div> | | | | |
| SURFACE QUALITY | 20-10 | 20-10 | | | | | |
| TRANSMITTED WAVEFRONT (P-V) | 0.10 WAVE | 0.10 WAVE | | | | | |
| CLEAR APERTURE | Ø32.00 | Ø32.00 | | | | | |
| BEVEL | PROTECTIVE AS NEEDED | PROTECTIVE AS NEEDED | | | | | |
| | | | ALL DIMS IN | mm | DWG NO | 11905 | SHEET 1 OF 1 |