

NOTES:

1. SUBSTRATE:
GERMANIUM (GE)
2. SURFACE S2 TO BE PARALLEL TO S1 WITHIN 1 ARCMIN
3. ANTI REFLECTION SURFACE TREATMENT (APPLY ACROSS CLEAR APERTURE)
S1 & S2: RAVG < 5.0% @ 3 - 12µm

4. FINE GRIND SURFACE

5. RoHS COMPLIANT

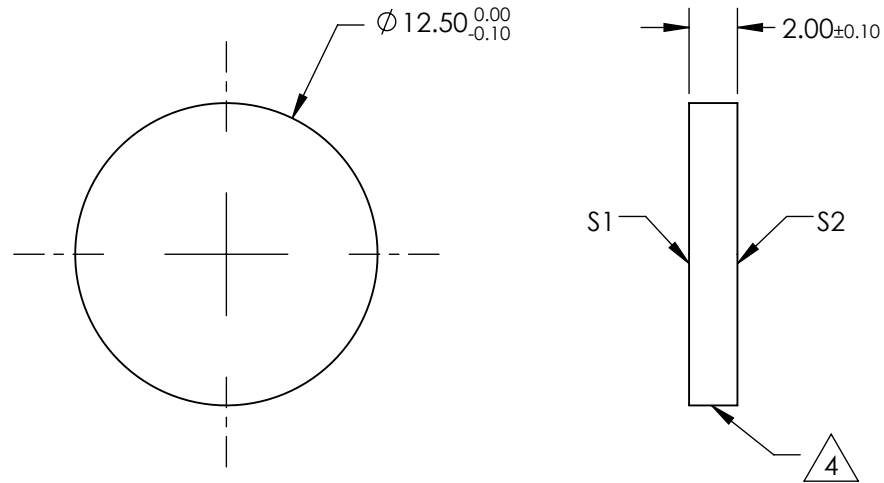
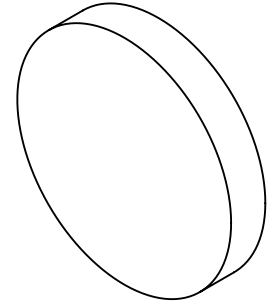

**FOR INFORMATION ONLY:
DO NOT MANUFACTURE
PARTS TO THIS DRAWING**

SPECIFICATIONS SUBJECT TO CHANGE WITHOUT NOTICE
DIMENSIONS ARE FOR REFERENCE ONLY

| | S1 | S2 |
|------------------|--------------------------------|--------------------------------|
| SHAPE | PLANO | PLANO |
| SURFACE QUALITY | 60-40 | 60-40 |
| SURFACE FLATNESS | $\lambda/10 @ 10.6\mu\text{m}$ | $\lambda/10 @ 10.6\mu\text{m}$ |
| BEVEL | PROTECTIVE AS NEEDED | PROTECTIVE AS NEEDED |



ALL DIMS IN

mm

EO® Edmund Optics®

TITLE

Ø12.5mm x 2mm THICK, 3 - 12µm AR COATED,
GE WINDOW

DWG NO

62644

SHEET
1 OF 1