

	PART DESCRIPTION	MATERIAL
①	SM2RR	ANODIZED ALUMINUM
②	LA4337	UV FUSED SILICA
③	ENGRAVED HOUSING	ANODIZED ALUMINUM

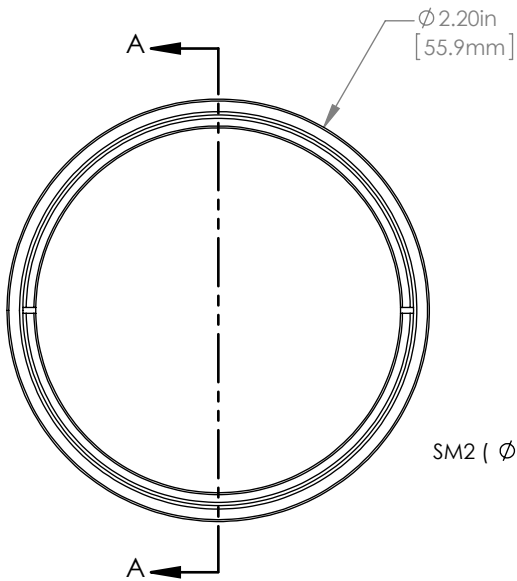

SM2 (ϕ 2.035-40) SERIES INTERNAL THREAD

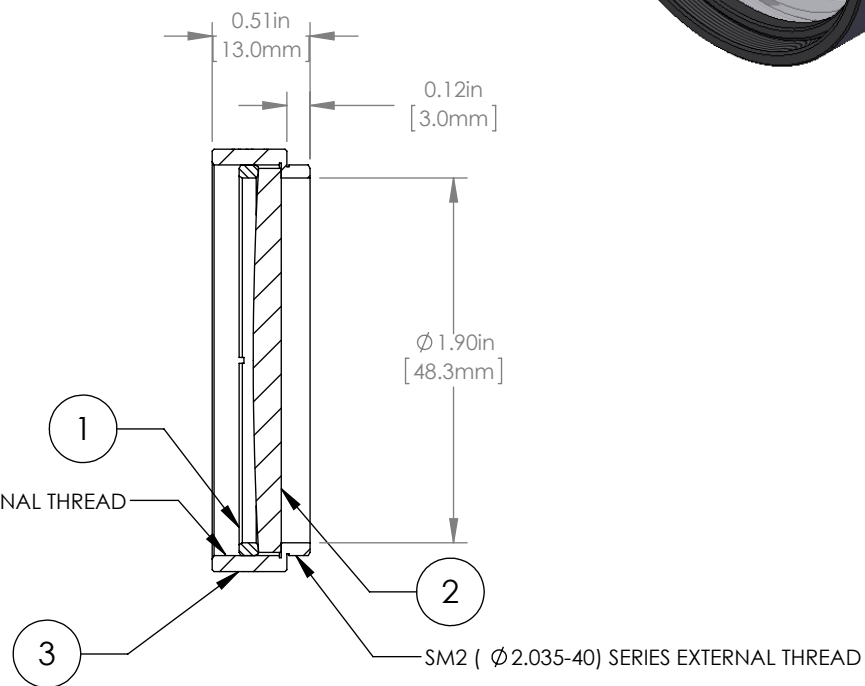

NOTES/SPECIFICATIONS:

- DESIGN WAVELENGTH: 546nm
- FOCAL LENGTH: $f=1000.0\text{mm} \pm 1\%$
- WORKING DISTANCE (REF): 993.7mm
- CLEAR APERTURE: $> \phi 45.72\text{mm}$
- SURFACE QUALITY: 40-20 SCRATCH-DIG

FOR INFORMATION ONLY
NOT FOR MANUFACTURING PURPOSES

DRAWING PROJECTION			 www.thorlabs.com ϕ 2" MOUNTED PLANO-CONVEX LENS, $f=1000\text{mm}$	
NAME	DATE			
DRAWN	GG	13/OCT/15	MATERIAL	
APPROVAL	DD	13/OCT/15	SEE TABLE	
COPYRIGHT © 2015 BY THORLABS <small>VALUES IN PARENTHESIS ARE CALCULATED AND MAY CONTAIN ROUND OFF ERRORS</small>			ITEM #	APPROX WEIGHT
			LA4337-ML	29 g

REV A