

	PART DESCRIPTION	MATERIAL
①	SM3RR	ANODIZED ALUMINUM
②	LA4372	UV FUSED SILICA
③	ENGRAVED HOUSING	ANODIZED ALUMINUM

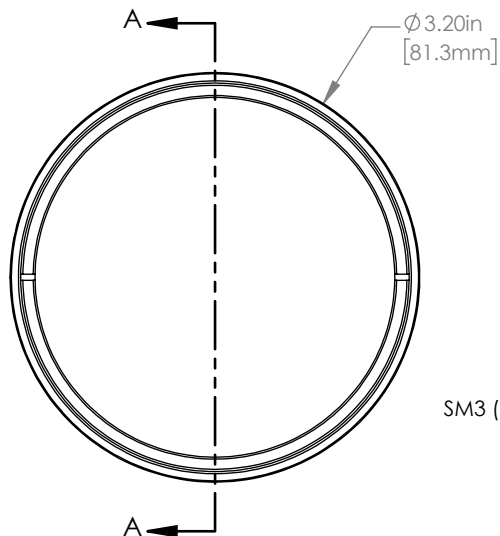

SM3 (ϕ 3.035-40) SERIES INTERNAL THREAD

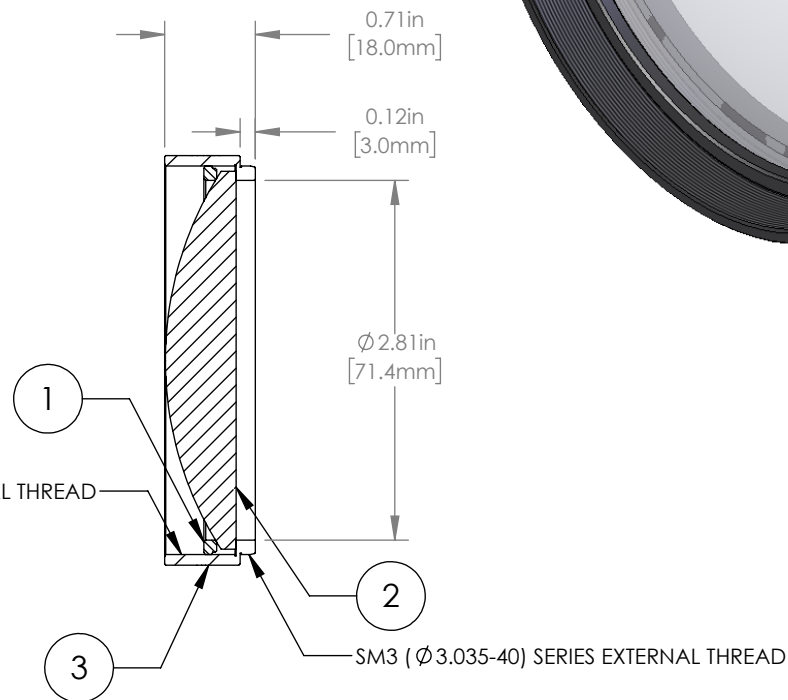

SM3 (ϕ 3.035-40) SERIES EXTERNAL THREAD

NOTES/SPECIFICATIONS:

1. DESIGN WAVELENGTH: 546nm
2. FOCAL LENGTH: $f=150.0\text{mm} \pm 1\%$
3. WORKING DISTANCE (REF): 136.6mm
4. CLEAR APERTURE: $> \phi 67.50\text{mm}$
5. SURFACE QUALITY: 40-20 SCRATCH-DIG

FOR INFORMATION ONLY
NOT FOR MANUFACTURING PURPOSES

DRAWING PROJECTION			THORLABS www.thorlabs.com	
NAME	DATE			
DRAWN	GG	13/OCT/15	ϕ 75.0mm MOUNTED PLANO-CONVEX LENS, $f=150\text{mm}$	
APPROVAL	DD	13/OCT/15	MATERIAL	REV
COPYRIGHT © 2015 BY THORLABS			SEE TABLE	A
VALUES IN PARENTHESIS ARE CALCULATED AND MAY CONTAIN ROUND OFF ERRORS			ITEM #	APPROX WEIGHT
			LA4372-ML	114 g