

NOTES:

1. SUBSTRATE MATERIAL:
FUSED SILICA
2. COATING:
S1: SURFACE ETCHED MULTI-LAYER DIELECTRIC GRATING
S2: ANTI-REFLECTION (AR)
3. DESIGN WAVELENGTH: 1040 ±20nm
ANGLE OF INCIDENCE: 31.3 ±1°
GROOVE DENSITY: 1000 GROOVES/mm
GROOVE UNIFORMITY: 0.001 GROOVES/mm
4. RoHS COMPLIANT

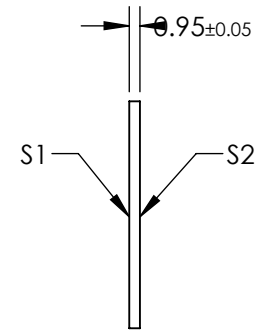
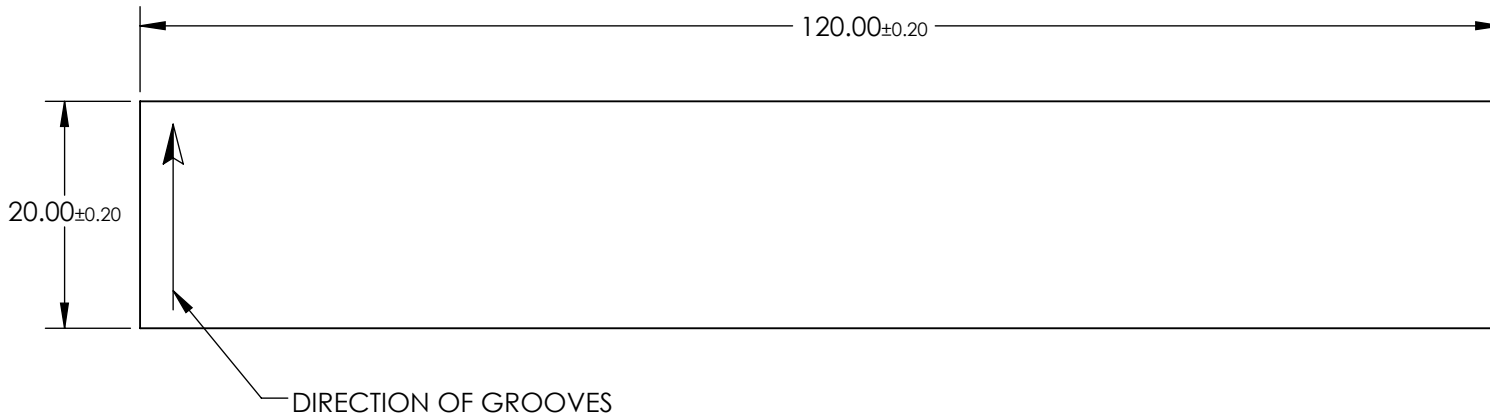
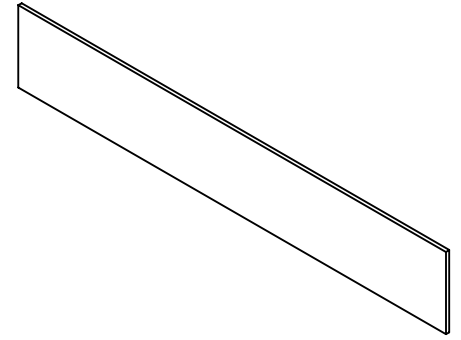

**FOR INFORMATION ONLY:
DO NOT MANUFACTURE
PARTS TO THIS DRAWING**

SPECIFICATIONS SUBJECT TO CHANGE WITHOUT NOTICE
DIMENSIONS ARE FOR REFERENCE ONLY

EO® Edmund Optics®

	S1	S2
SHAPE	PLANO	PLANO
SURFACE QUALITY	60-40	60-40
CLEAR APERTURE	115.00 x 18.00	115.00 x 18.00
BEVEL	PROTECTED AS NEEDED	PROTECTED AS NEEDED

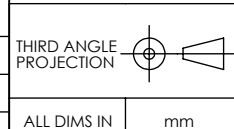

TITLE	II-VI LightSmyth™ 1040nm, 1000 Grooves/mm, 120 x 20mm Transmission Diffraction Grating		
DWG NO	16871	SHEET	1 OF 1

ALL DIMS IN

mm